



Crazy Metal **R e d e f i n e A r c h i t e c t u r a l s p a c e**





Crazy Metal has created a new era of architectural decoration. After 10 years of research and development, it has developed aircraft interior materials into a decorative material suitable for global high-end buildings-stainless steel honeycomb panels.

Using "stainless steel honeycomb panel" as the base material, Crazy Metal has developed "stainless steel shaped walls, stainless steel hanging column, stainless steel partition chandeliers, and stainless steel DIY cabinets" suitable for high-end projects.

Crazy Metal is willing to cooperate with world-renowned designers to serve the global high-end customization scenes and jointly realize the dream of "redefining architectural space";

The projects we have done include: Fairmont's Century Arch, Triumph Hotel's suspended water column, DJI's dream partition, and Vanke Villa's stainless steel DIY art cabinet, leading the trend of stainless steel architecture.

We are very happy to share with you our specially developed designer support program, so that you can complete the design and decoration projects more easily and smoothly, so as to help you raise your reputation in the industry. Your design expertise together with our new materials make us a successful combination and are doomed to create architectural history.

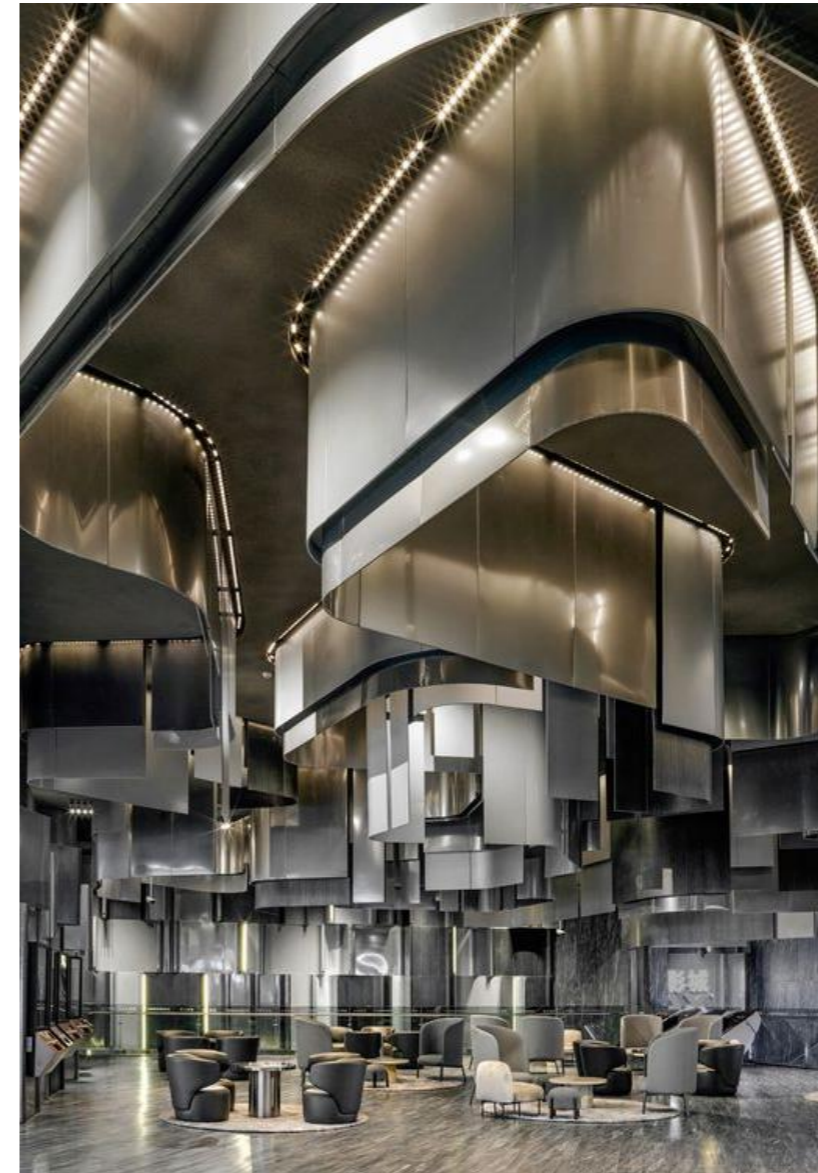

// Why Crazy Metal

Crazy metal provides the beyond-your-imagination solution to realize your design that you can not do with the traditional materials. Our expert engineer team helps you with your dream design and turn your drawings into creation.

Engineering assistance:

- *Detailed drawings from your design
- *3D rendering for design reference
- *Installation instruction
- *Specification and technical information

Commercial assistance:

- *Online video meeting for technical and commercial communication
- *Online factory video audit. Zero worry, full trust
- *Favorable payment term for big projects
- *Free samples (standard size)

Full supply chain support:

- *over 3000 finishes, colors and grains for choice
- *Different material combination
- *All kinds of accessories sourcing
- *Various fabrication process

Professional Capability:

- *International projects background
- *Help winning the bids
- *Outstanding products
- *Easy to install system



// Material introduction for stainless steel honeycomb panel

The stainless steel honeycomb composite panel exterior wall is a high-level building decoration material used only in the aerospace industry in the past. The surface of the board is a stainless steel plate, and the middle layer is an aluminum foil honeycomb structure (stainless steel honeycomb can also be used), which has excellent rigidity, and the metal curtain wall material is the best product. This product is widely used in modern architecture and decoration, train, automobile and shipbuilding and other manufacturing industries.

Wherein, PVDF color surface protective layer of stainless steel honeycomb panels against weathering, durability and chemical resistance with excellent color and other aspects of performance, it can be widely used in a variety of climates, from cold and dry to hot and humid Nordic equatorial zone can be used.



Crazy Metal

// Characteristics of stainless steel honeycomb panel

- Light weight (20-30kgs per sqm)
- Good rigidity
- Flat and straight
- Fire proof
- water proof
- weather proof
- sound and heat insulation
- high impact resistance
- Corrosion Resistance- 100% recyclable
- Easy to Sanitize
- various custom thickness

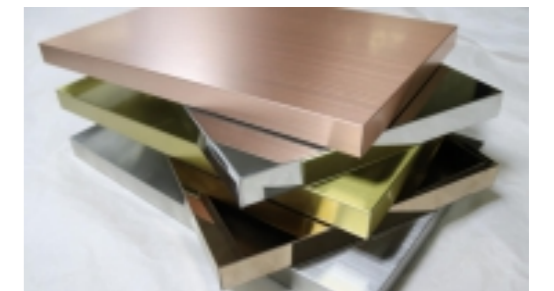
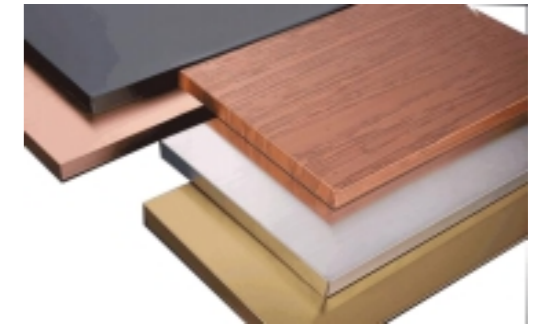
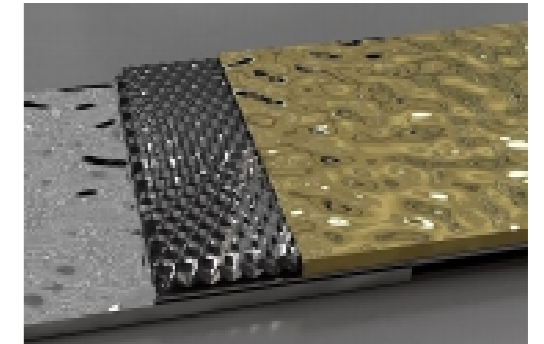

Crazy Metal

// Stainless Steel Honeycomb Panel

The stainless steel honeycomb panel has a 5-layer structure, and the aluminum honeycomb core is bonded with two aviation epoxy films and two stainless steel as the surface sheet. While maintaining its mechanical strength and function, it greatly reduces the weight of the stainless steel plate and substrate.

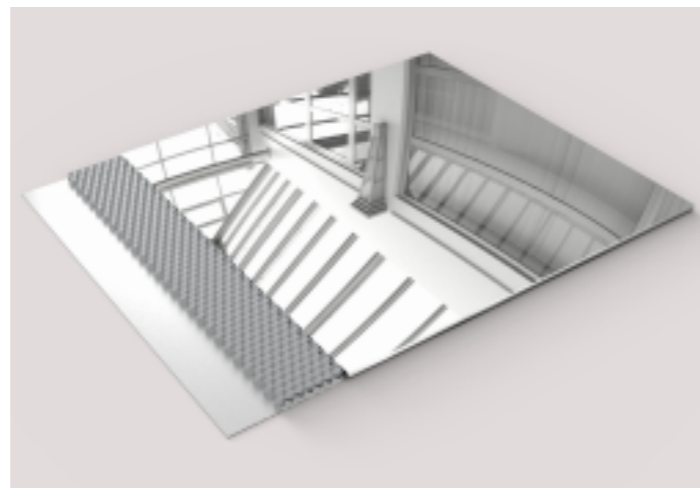
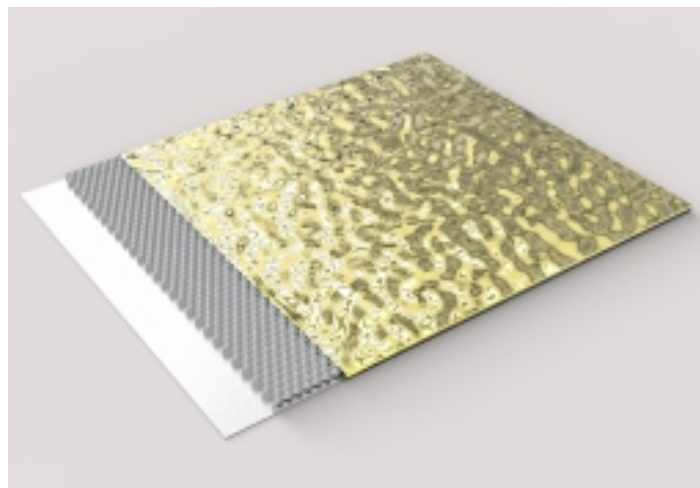
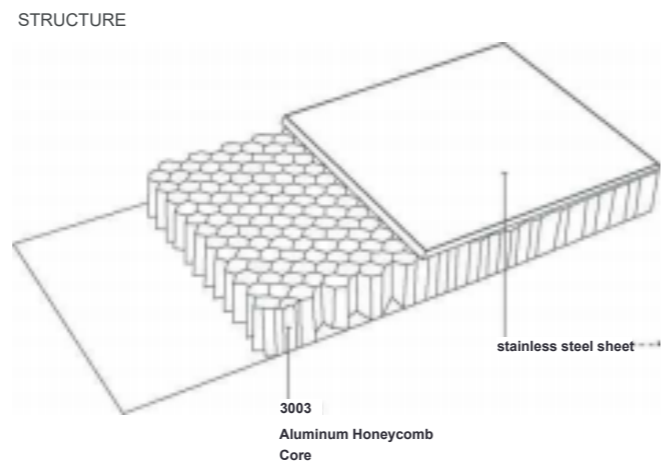

// Aluminum Honeycomb Core

The aluminum honeycomb core is composed of multilayer aluminum foil. Aluminum honeycomb core has sharp and clear hole surface and it is suitable for adhering to high grade panels. Honeycomb is formed and has great strength support to the surface stainless steel skin after fully expanded.

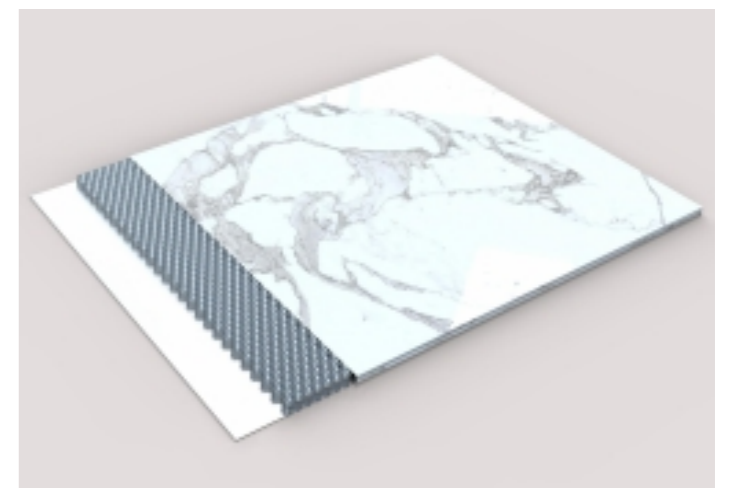
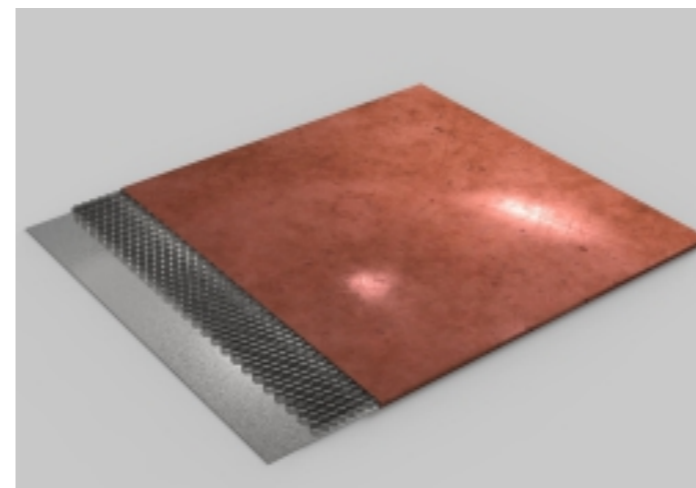
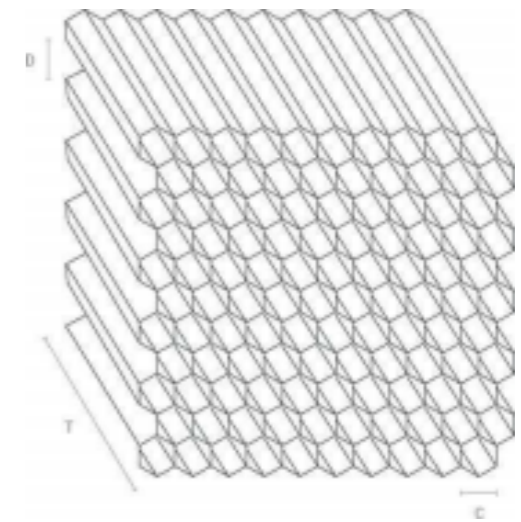

// CrazyMetal Honeycomb Panels Manufacturer's Certificates



// Crazy metal product Features

- *Light weight : 20-30KG per sqm
- *Pre-formed and sized
- *Ready to install
- *Can be empty at any part
- *Can be away from the floor
- *Can be tilt
- *Can be joined with other material
- *Can insert lighting strip
- *Simple installation

- *Can be various thickness
- *Can be dismantled and reinstalled in other places
- *Modular design and manufacturing
- *key-slot installation
- *No need substrate material
- *Labor cost saving installation
- *Custom design / size / scalability
- *Can be curve

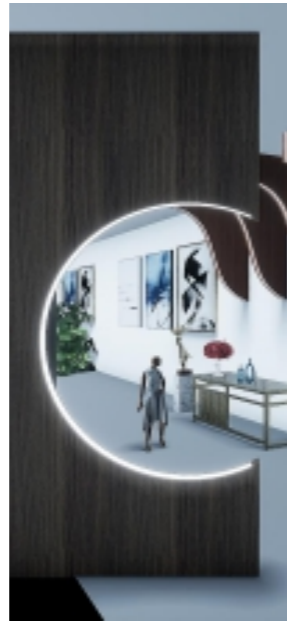
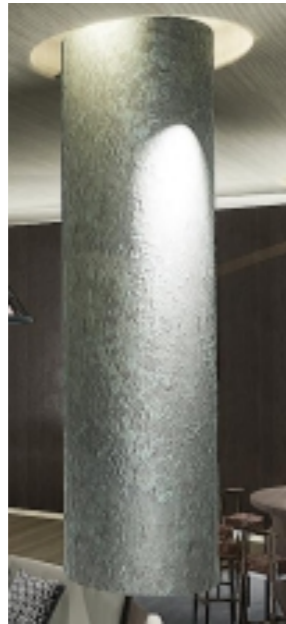

// Choose your color / grain / finish

Wide range of stainless steel with over 3,000 possible options. Simply choose a base material, grain, color, along with protective finish to instantly transform your space.

Colors

Our Collections offer over 1000 colors.

Grains

Our Collections offer over 300 grains.

Finishes

Our Collections offer over 300 finishes including PVD, powder coating, painting, Nano coating.

Lifetime

Our base color and finish offers a 30 years indoor and 10 year's outdoor warranty. Our outdoor special coating with over 20 year's warranty.

Copper stainless steel honeycomb plate

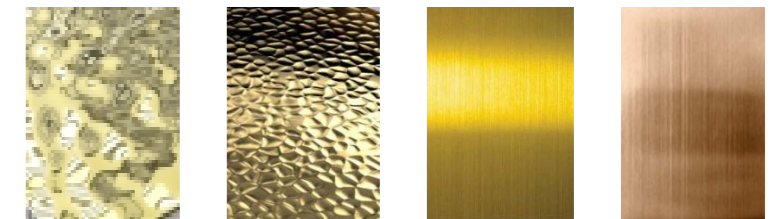

Silver stainless steel honeycomb panel

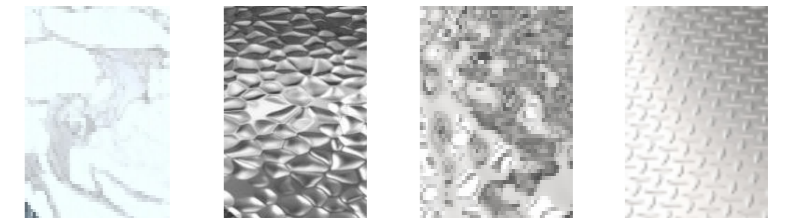

Gray stainless steel honeycomb panel

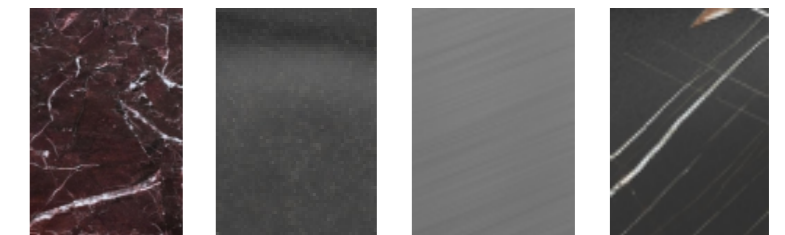

// Choose your Products



COLUMNS



WALL PANELS



MODELING WALL



CEILING SYSTEM

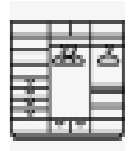

WARDROBE / CABINET

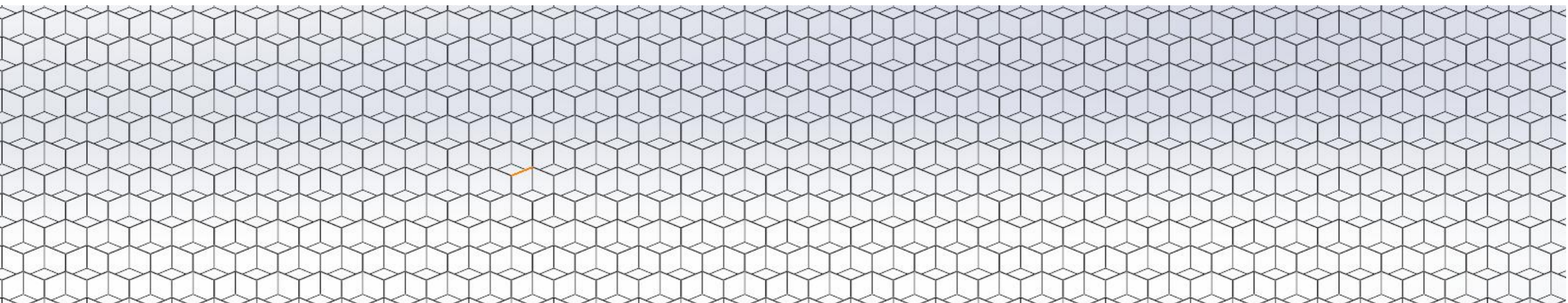

Crazy metal ceiling system

Our pre-formed and sized ceiling system help greatly save the time and labor cost while achieving most upscale look to your commercial or office space. With simple brackets and hanging poles they take short time and less labor to complete the installation.



Crazy Metal

Crazy Metal

Features:

- *Modular solution for your easy installation.
- *Special water ripple effect creates a flowing atmosphere
- *Custom pre-formed and sized stainless stain honeycomb panels
- *No need substrate material
- *Can be dismantled and reinstalled in other area

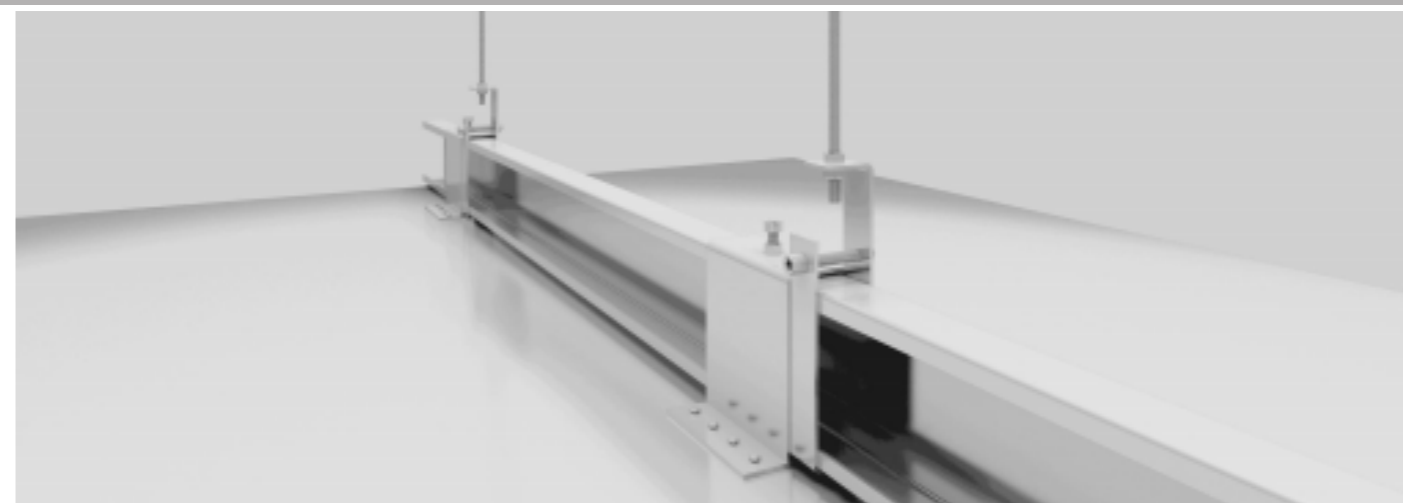

Crazy metal wall cladding panels

Our pre-formed and sized wall panels has great rigidity and perfect flatness with different grains and colors to achieve the most upscale look to your commercial or office space. With simple brackets and wall hanging profiles they take short time to complete the installation with tiny gap.



Crazy Metal

Crazy Metal

Features:

- *Modular solution for your easy installation.
- *Special water ripple effect creates a flowing atmosphere
- *Custom pre-formed and sized stainless stain honeycomb panels
- *No need substrate material
- *Can be dismantled and reinstalled in other area
- *Can be up to 8 meters long

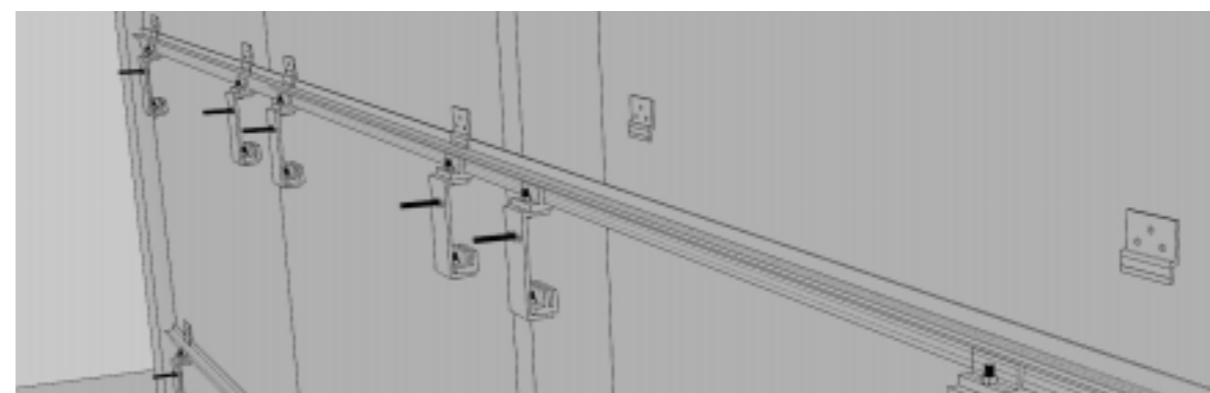

Crazy metal columns/hanging columns

Standing column cover / hanging column

Our pre-formed and sized columns help greatly save the time and labor cost while achieving most upscale look to your commercial or office space. With simple brackets and hanging poles they take short time to complete the installation. The hanging half columns can be inserted with lighting strips to be big lighting set. The hanging half column can also be combined with waterfall function

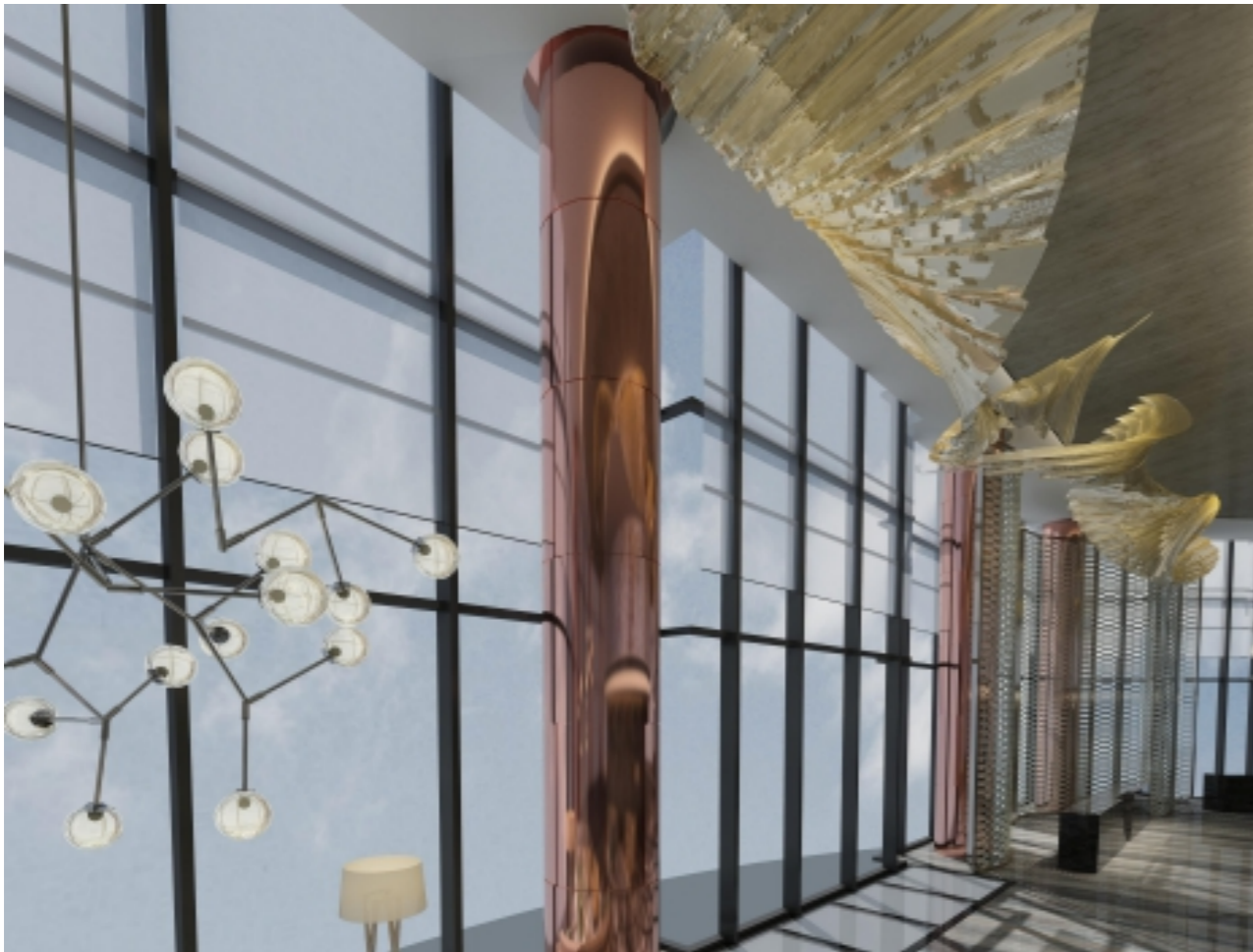

Crazy Metal

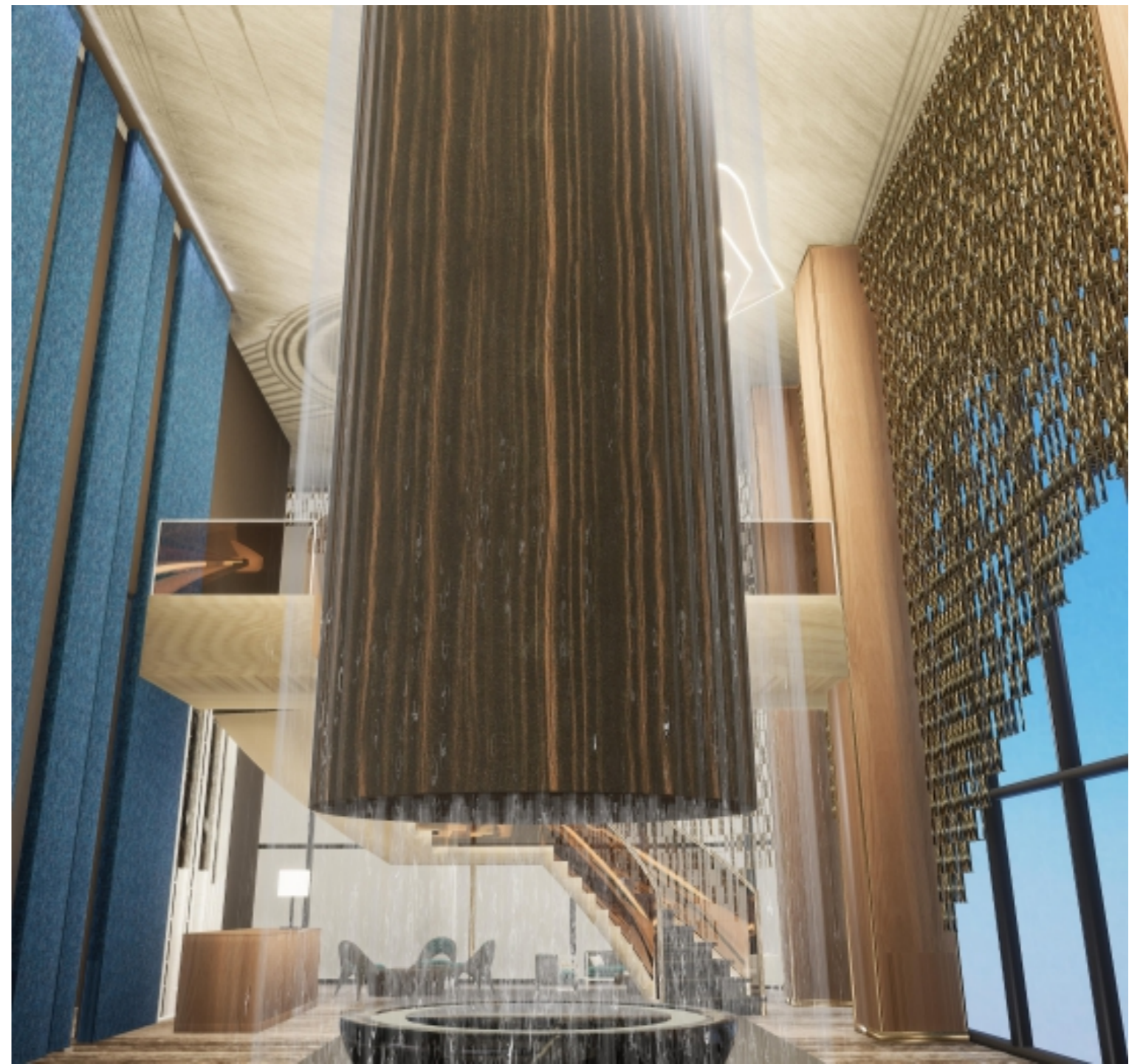

Crazy Metal

Features:

- *Ready-to-install solution for your easy installation
- *Custom pre-formed and sized stainless stain honeycomb panels
- *No need substrate material
- *Can be dismantled and reinstalled in other area
- *Can be full column or hanging half column just for decoration with its light-weight feature
- *It has great strength and flatness
- *Can be round, oval, square shape

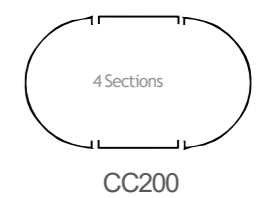
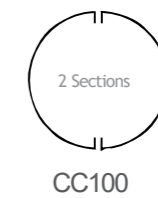
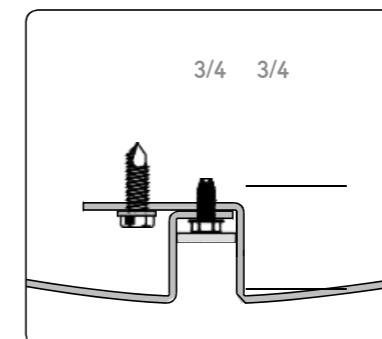
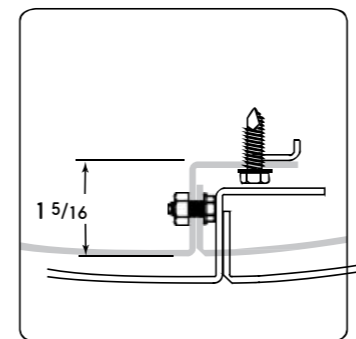

Crazy metal modeling wall

Our pre-formed and sized modeling walls help greatly save the time and labor cost while achieving most upscale look to your commercial or office space. With simple brackets and hanging poles they take short time to complete the installation. They can combine other materials as well as LED lighting.



Crazy Metal

Crazy Metal

Features:

- *Ready-to-install solution for your easy installation.
- *Special water ripple effect creates a flowing atmosphere
- *Custom pre-formed and sized stainless stain honeycomb panels
- *Can be dismantled and reinstalled in other area
- *Can integrate LED lighting inside

- *Can be curve
- *Can integrate with other material
- *Can be partition wall or decoration wall
- *Can be empty in the middle for special purpose
- *Can be any thickness

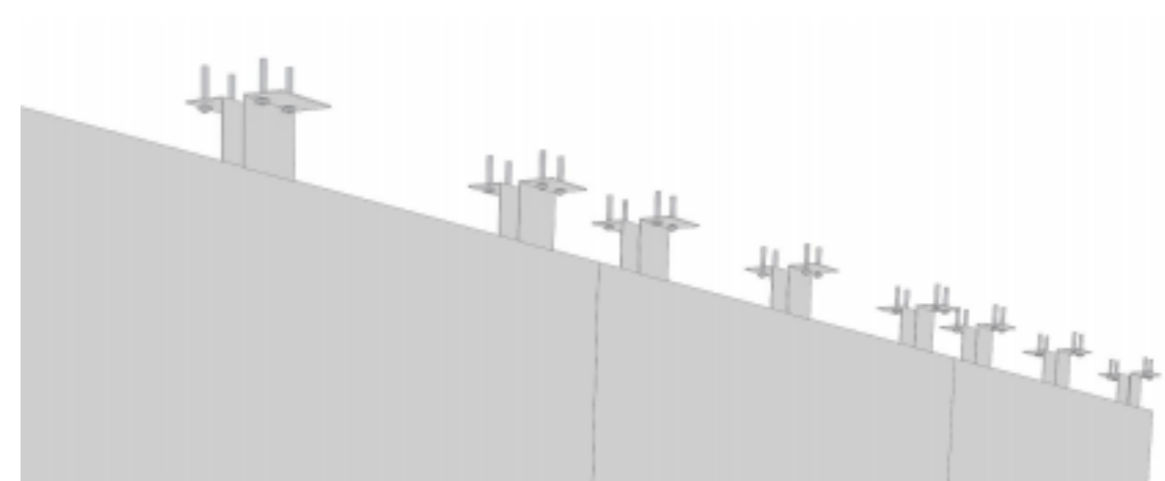

Crazy metal hanging wall

Our pre-formed and sized hanging walls help greatly save the time and labor cost while achieving most upscale look to your commercial or office space. With simple brackets and hanging poles they take short time to complete the installation. It breaks the limits of the traditional heavy wall and gives you freedom for the designs. They can integrate with LED strips and form big lighting fixtures.



Crazy Metal

Features:

- *Ready-to-install solution for your easy installation.
- *Special water ripple effect creates a flowing atmosphere
- *Custom pre-formed and sized stainless stain honeycomb panels
- *Can be dismantled and reinstalled in other area
- *Can integrate LED lighting inside

- *Can be curve
- *Can integrate with other material
- *Can be partition wall or decoration wall
- *Can be empty in the middle for special purpose
- *Can be any thickness



Crazy Metal

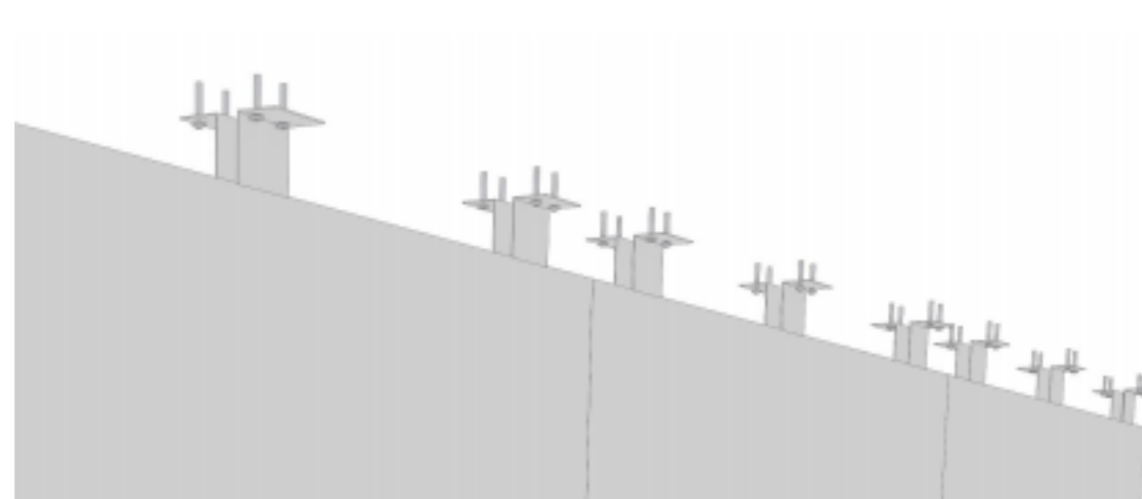

Crazy metal wardrobe / cabinet

Our stainless steel honeycomb panel can be precisely made into wardrobe / cabinet to your custom sizes with complete accessories. Our cabinets are shipped with pre-formed and sized panels unassembled and can be assembled with easy process. They can be dissembled easily and reassembled in other places.

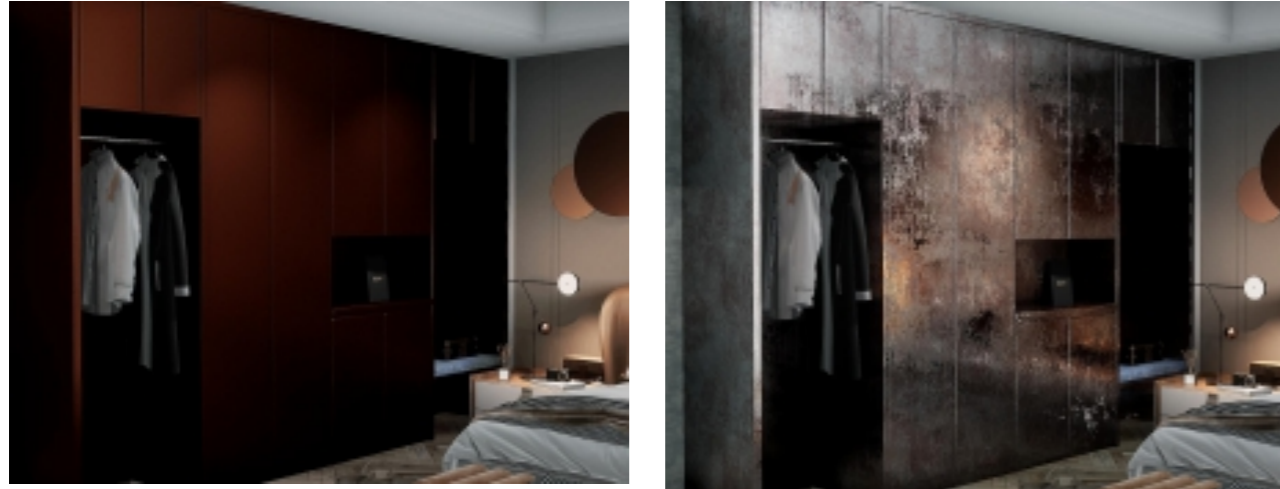

Crazy Metal



Crazy Metal

Features:

- *Ready-to-install solution for your easy installation.
- *Custom pre-formed and sized stainless stain honeycomb panels
- *Can be dissembled easily and reassembled in other places
- *Can integrate LED lighting inside
- *Water proof and insect proof with pre-long lifetime
- *Never deform

// Choose your Finish

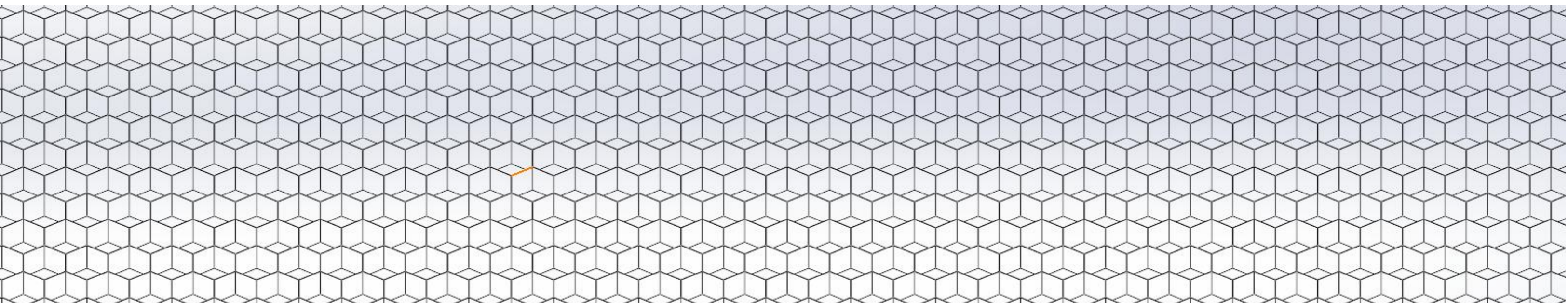
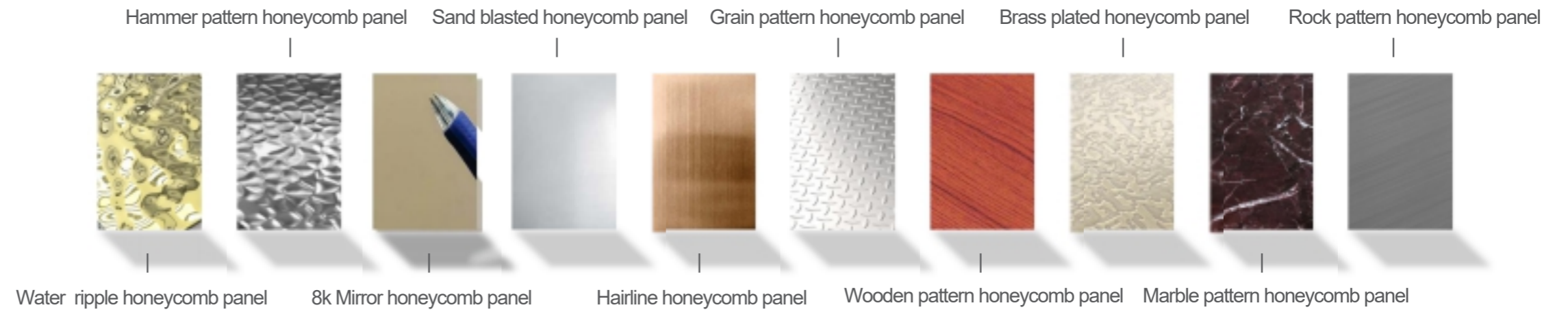



Water ripple honeycomb panel

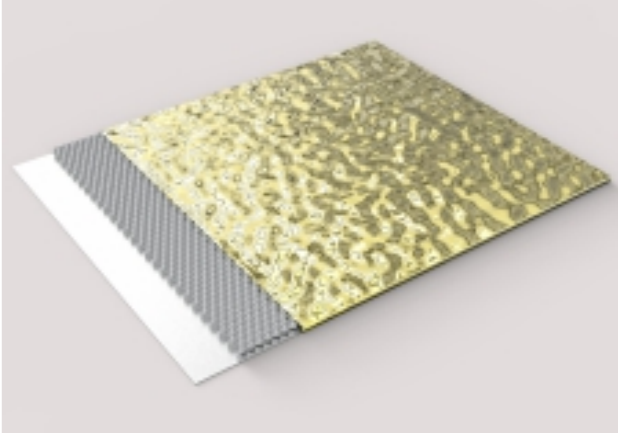

[COLLECTION]

Water ripple honeycomb panel

The surface of water ripple pattern of stainless steel honeycomb panel is pressed by a large mould.

Water ripple pattern of stainless steel honeycomb panel can help designers create their ideas.

For example:

hanging columns

Hanging wall

Ultra thin modeling wall

Super thick modeling wall

ceiling system

Insect proof / waterproof / formaldehyde free / corrosion resistance, suitable for seashore environment



CLASSIC COLLECTION

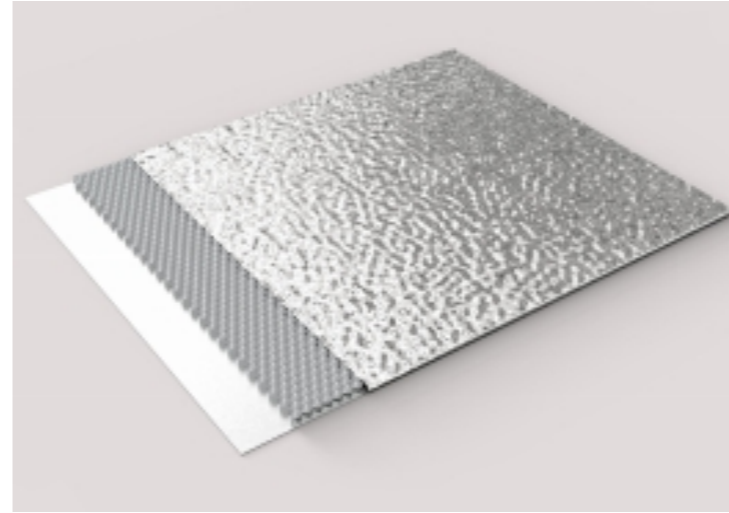

CM-BW801

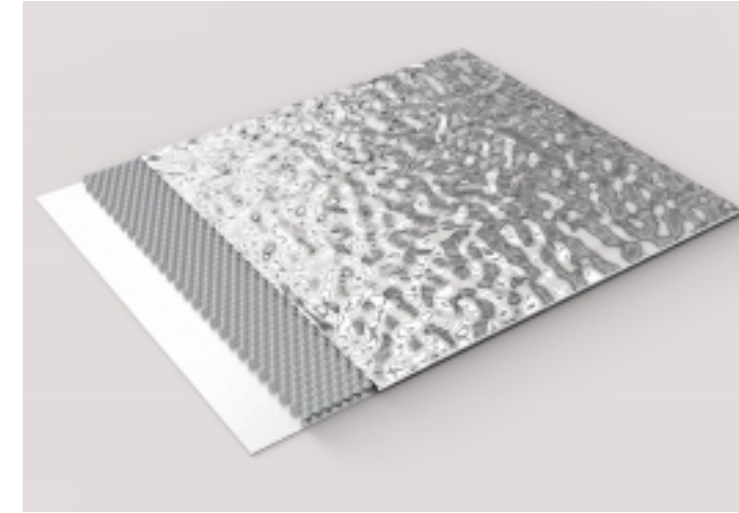

CM-BW802

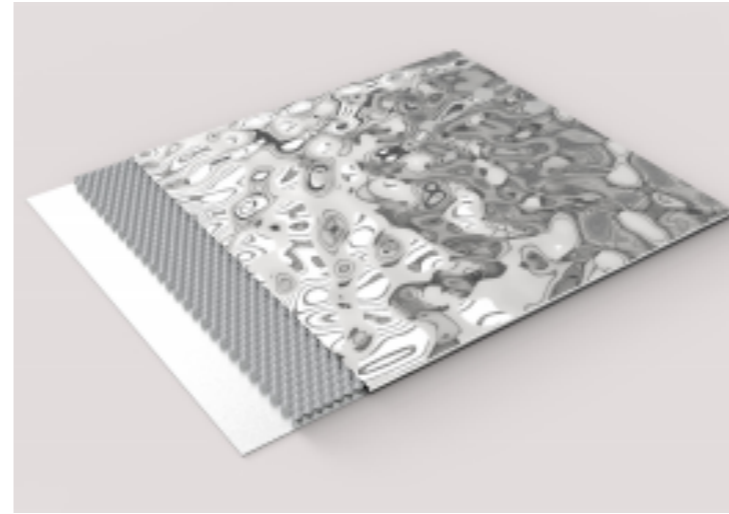

CM-BW803

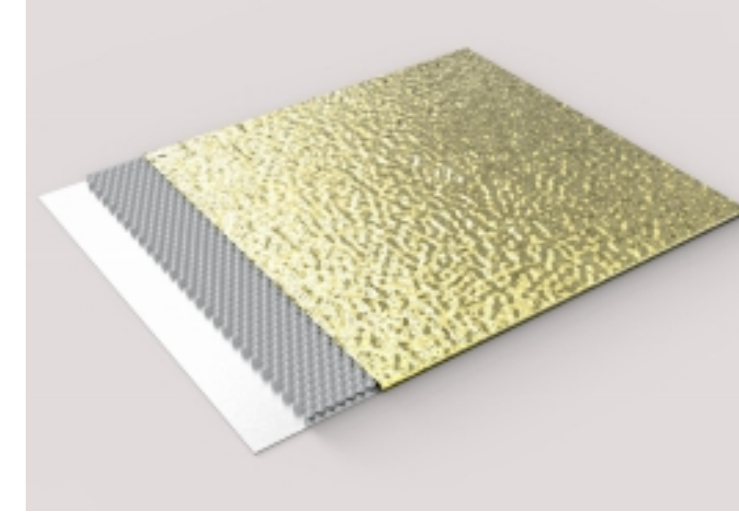

CM-BW804

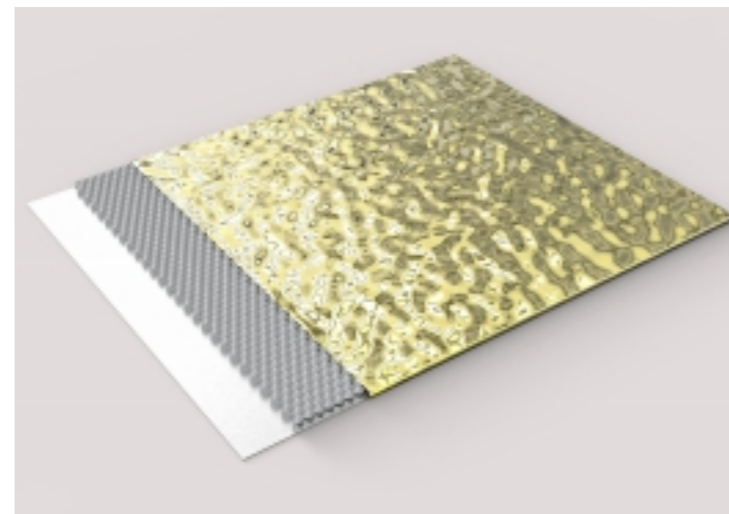

CM-BW805

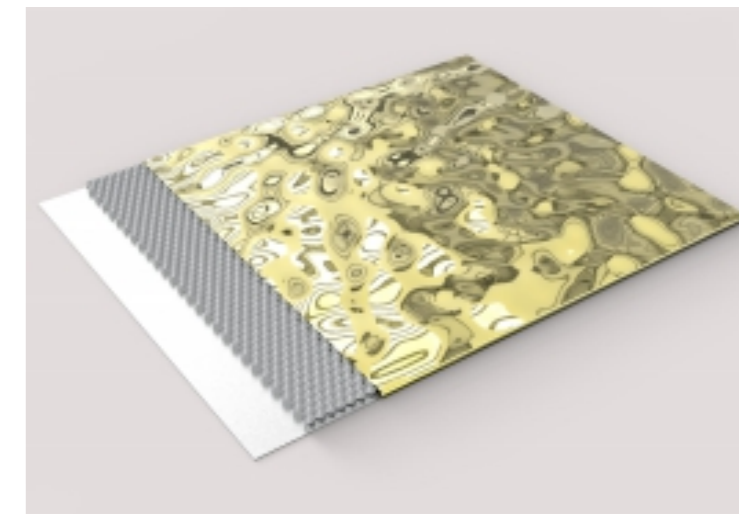

CM-BW806



Hammer pattern honeycomb panel

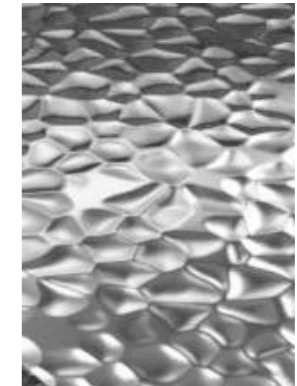
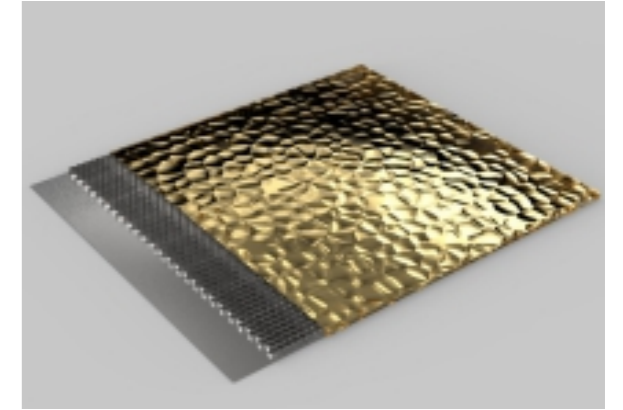
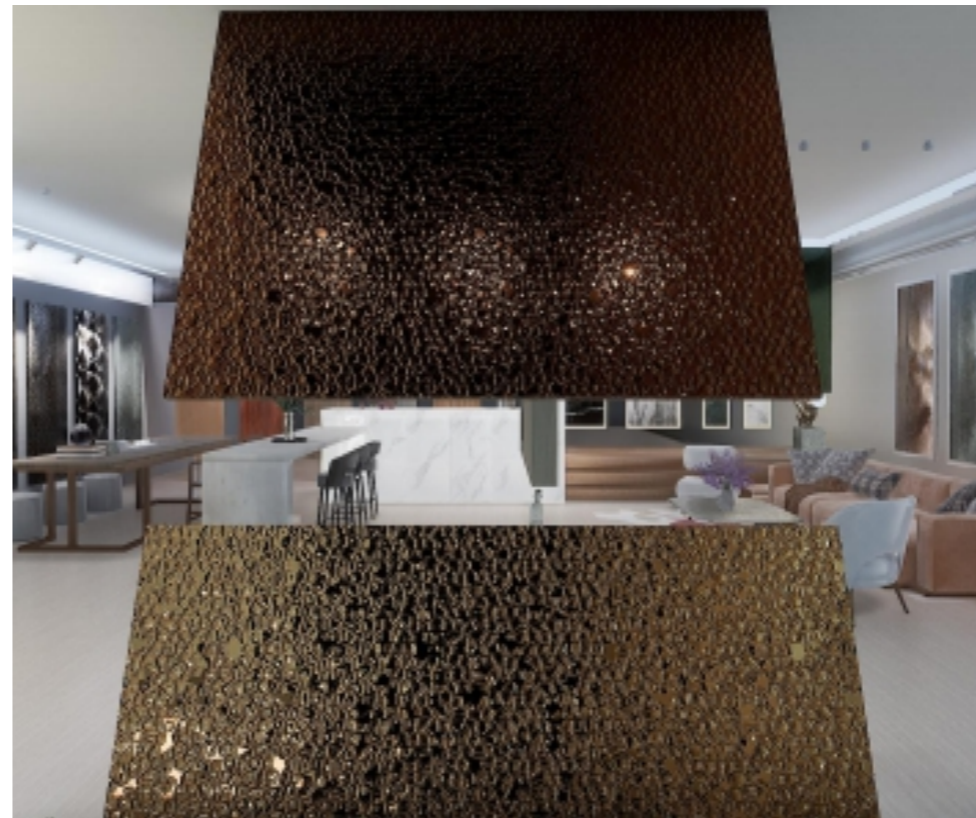

[COLLECTION]

Hammer pattern honeycomb plate

The surface of Hammer pattern of stainless steel honeycomb panel is pressed by a large mould. Hammer pattern of stainless steel honeycomb panel can help designers create their ideas.

- For example:
hanging columns
Hanging wall
Ultra thin modeling wall
Super thick modeling wall
ceiling system
Insect proof / waterproof / formaldehyde free / corrosion resistance, suitable for seashore environment



CLASSIC COLLECTION

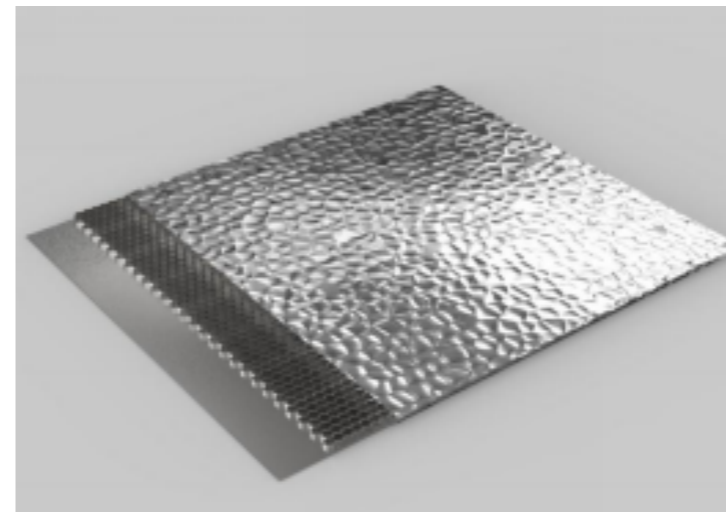

CM-YH801

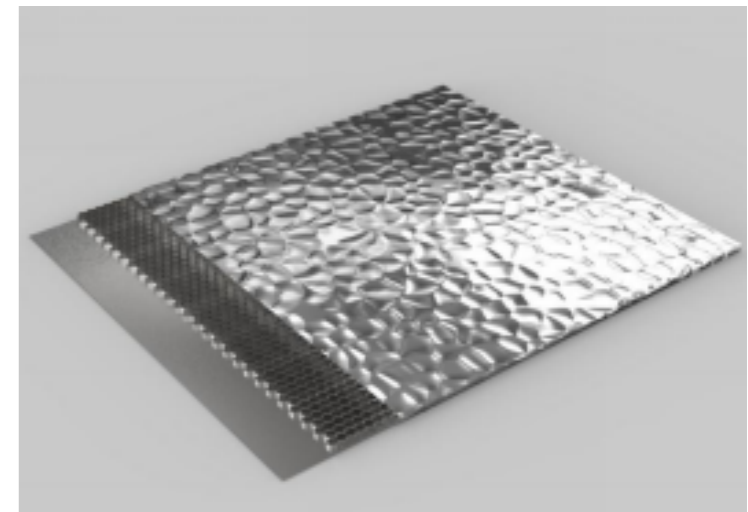

CM-YH802

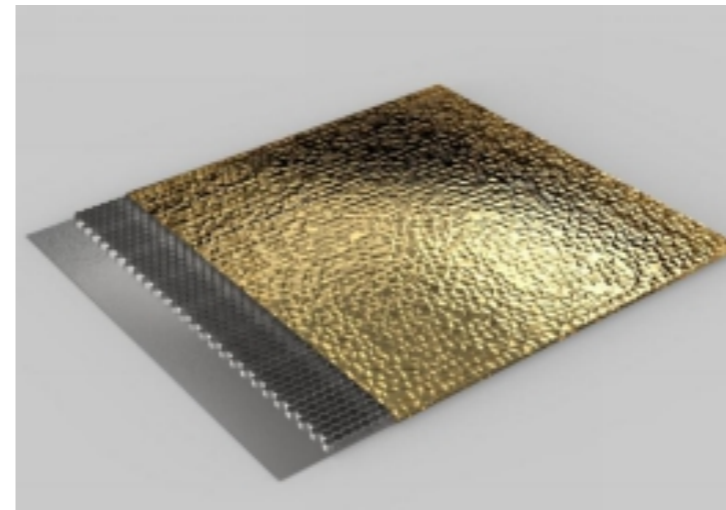

CM-YH803

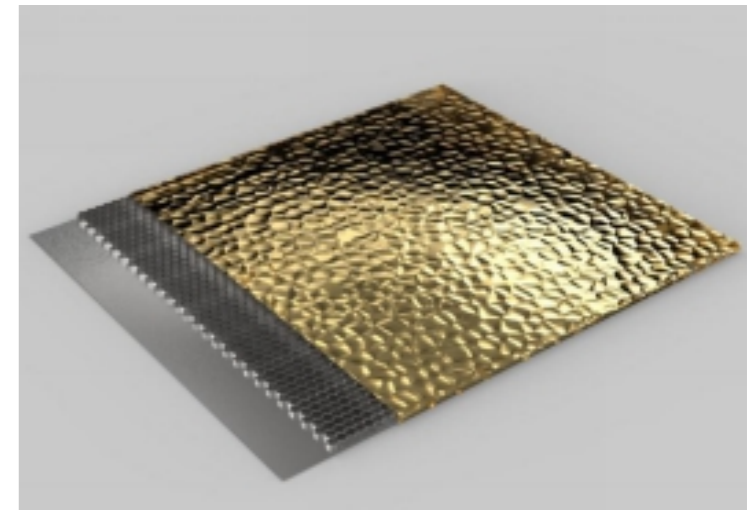

CM-YH804

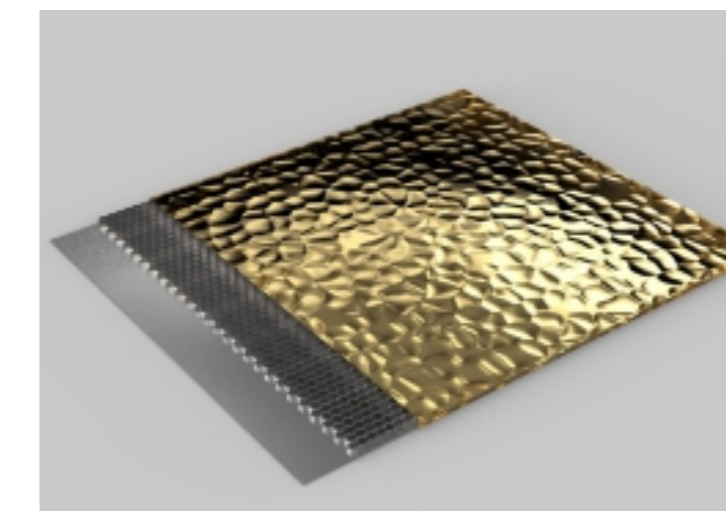

CM-YH805

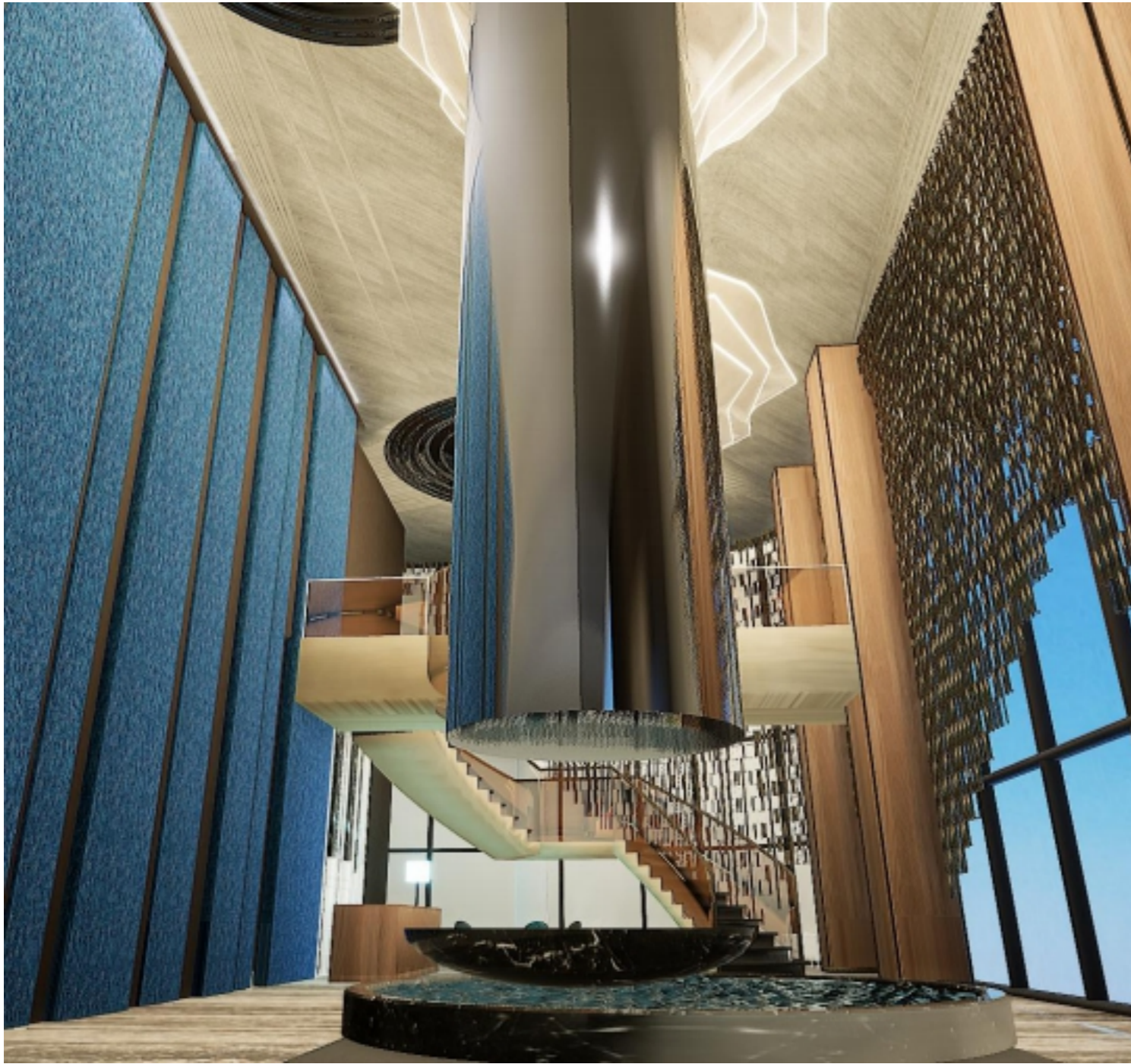

8k Mirror honeycomb panel

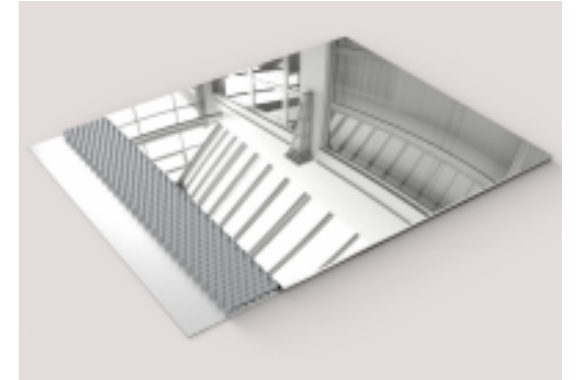
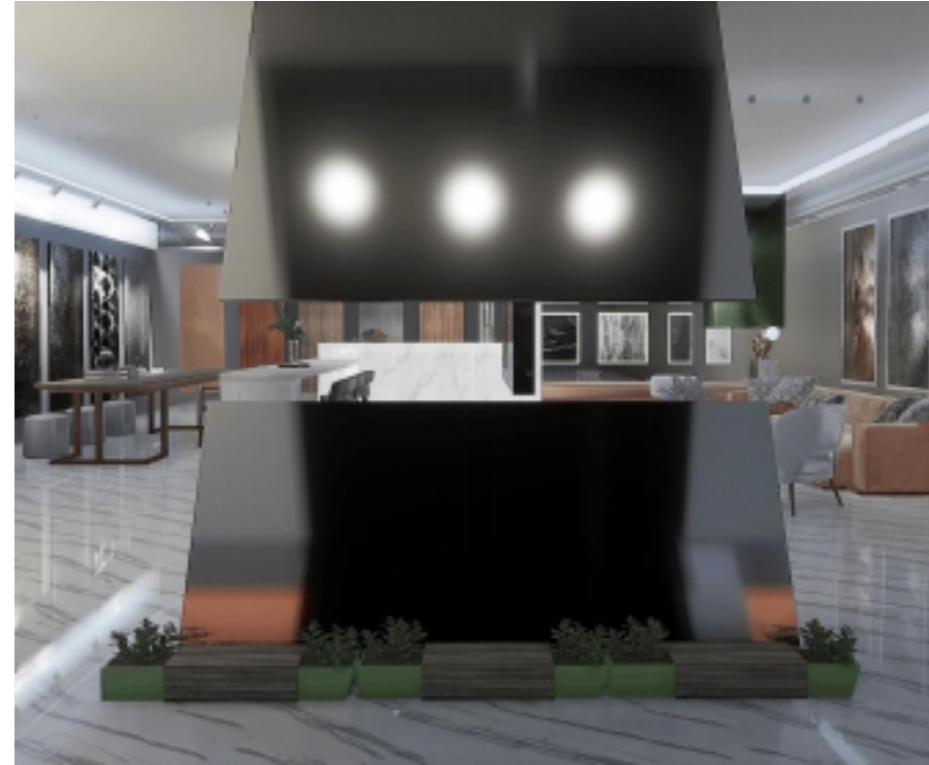

[COLLECTION]

8k Mirror honeycomb panel

The surface of 8k Mirror stainless steel honeycomb panel is pressed by by Polishing treatment and titanium plating
8k Mirror stainless steel honeycomb panel can help designers create their ideas.

For example:

hanging columns

Hanging wall

Ultra thin modeling wall

Super thick modeling wall

ceiling system

Insect proof / waterproof / formaldehyde free / corrosion resistance, suitable for seashore environment



CLASSIC COLLECTION

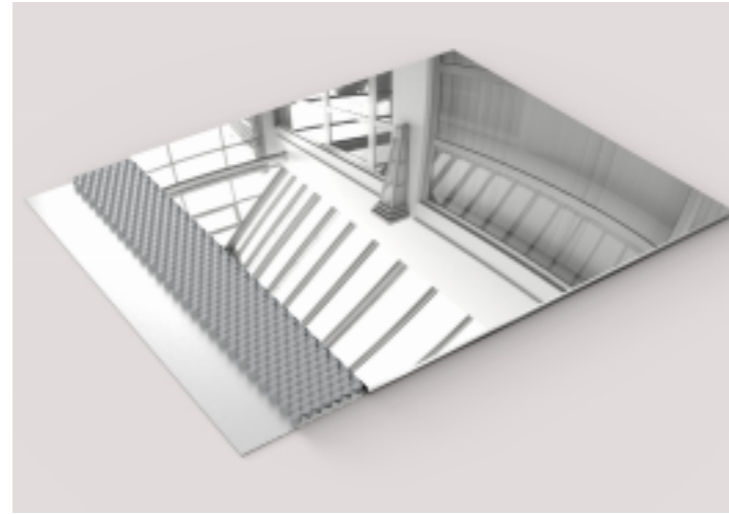

CM-MI801

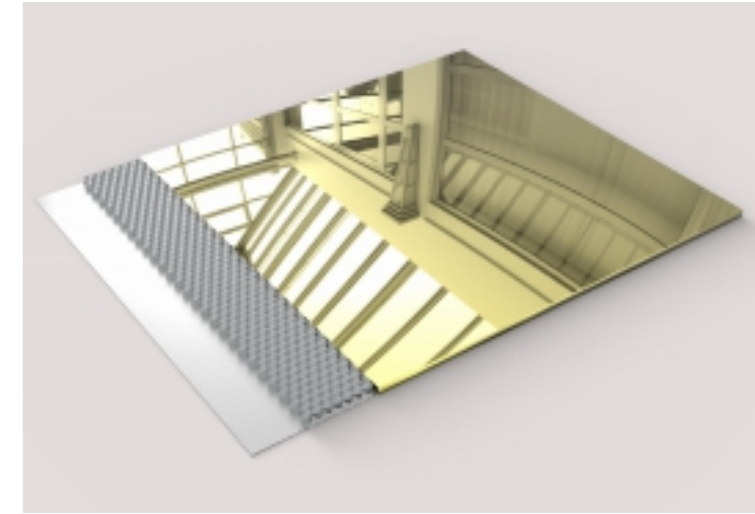

CM-MI802

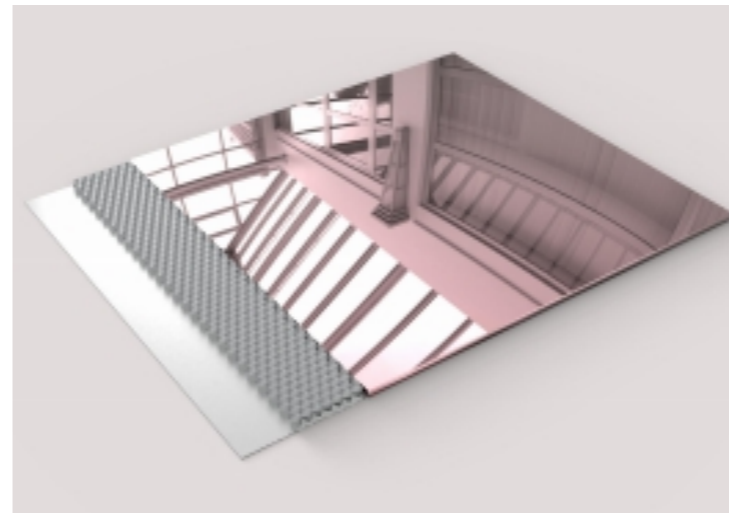

CM-MI803

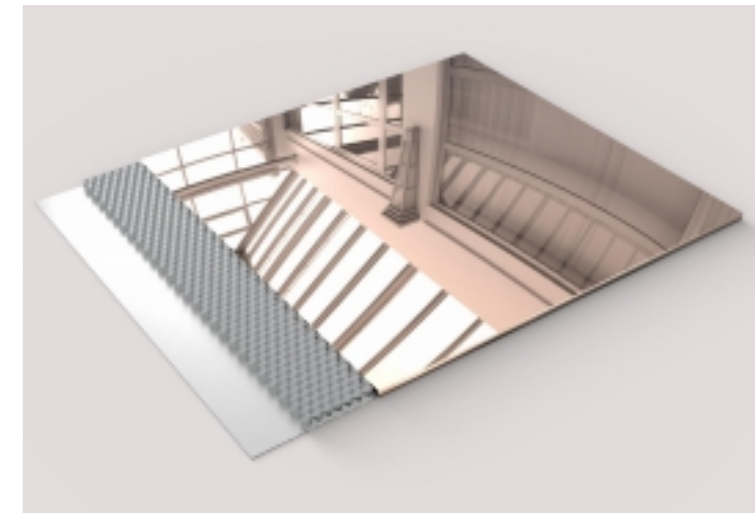

CM-MI804

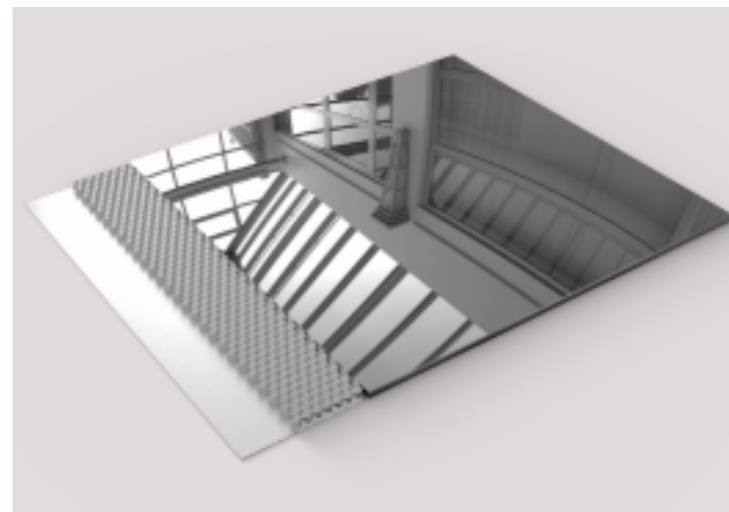

CM-MI805



Sand blasted honeycomb panel

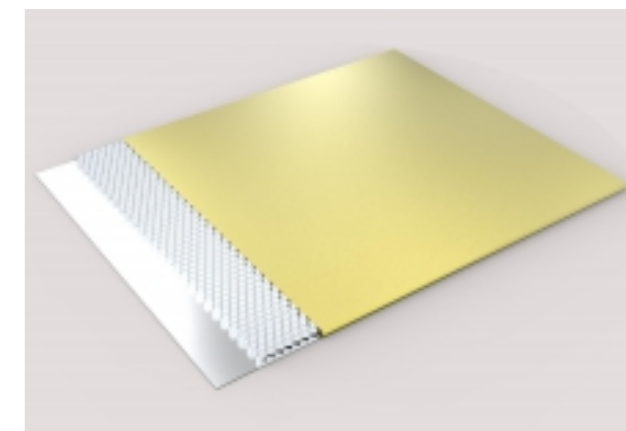

Sand blasted honeycomb panel

The surface of sand blasted stainless steel honeycomb panel by Sand blasting and titanium plating sand blasted stainless steel honeycomb panel can realize many ideas of designers

For example:

hanging columns

Hanging wall

Ultra thin modeling wall

Super thick modeling wall

ceiling system

Insect proof / waterproof / formaldehyde free / corrosion resistance, suitable for seashore environment



GRADIENTS COLLECTION

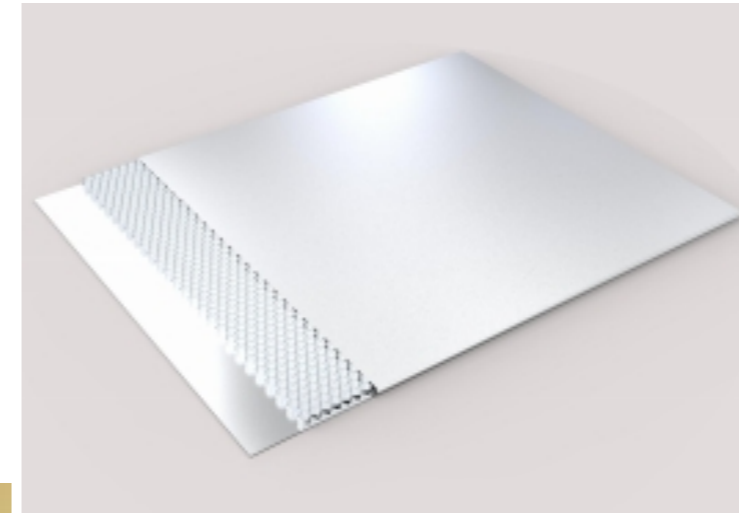

CM-PS801

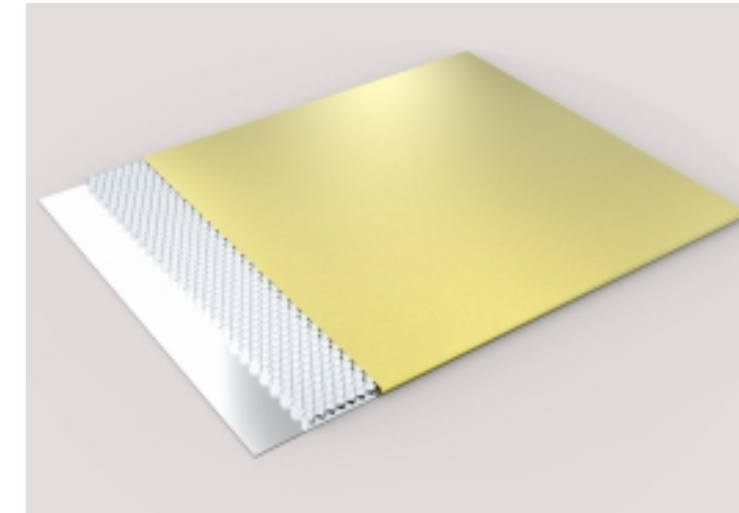

CM-PS802

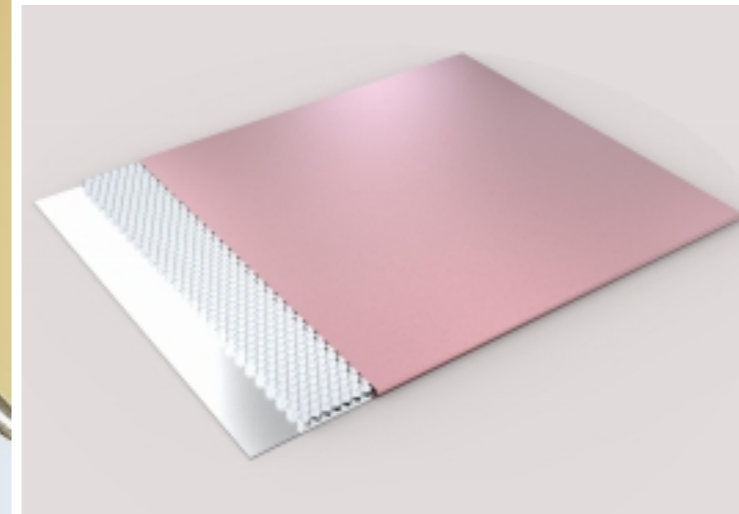

CM-PS803

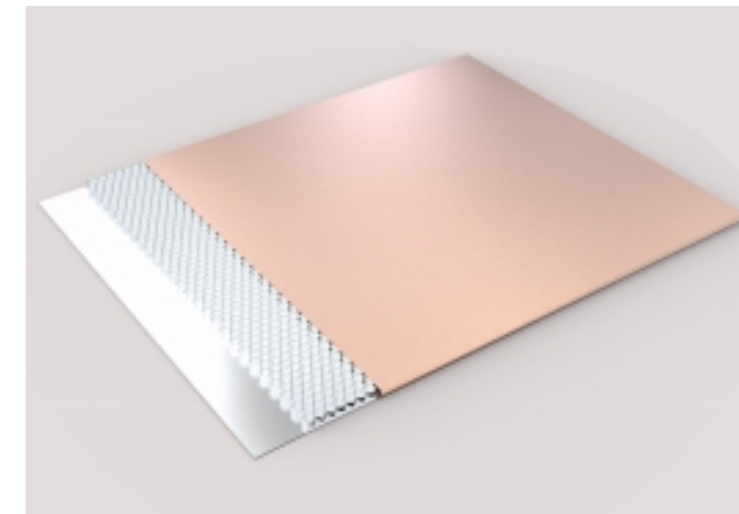

CM-PS804

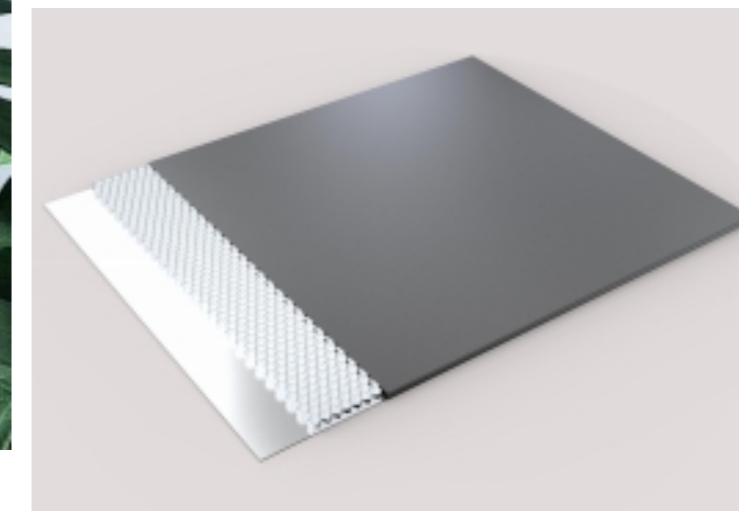

CM-PS805

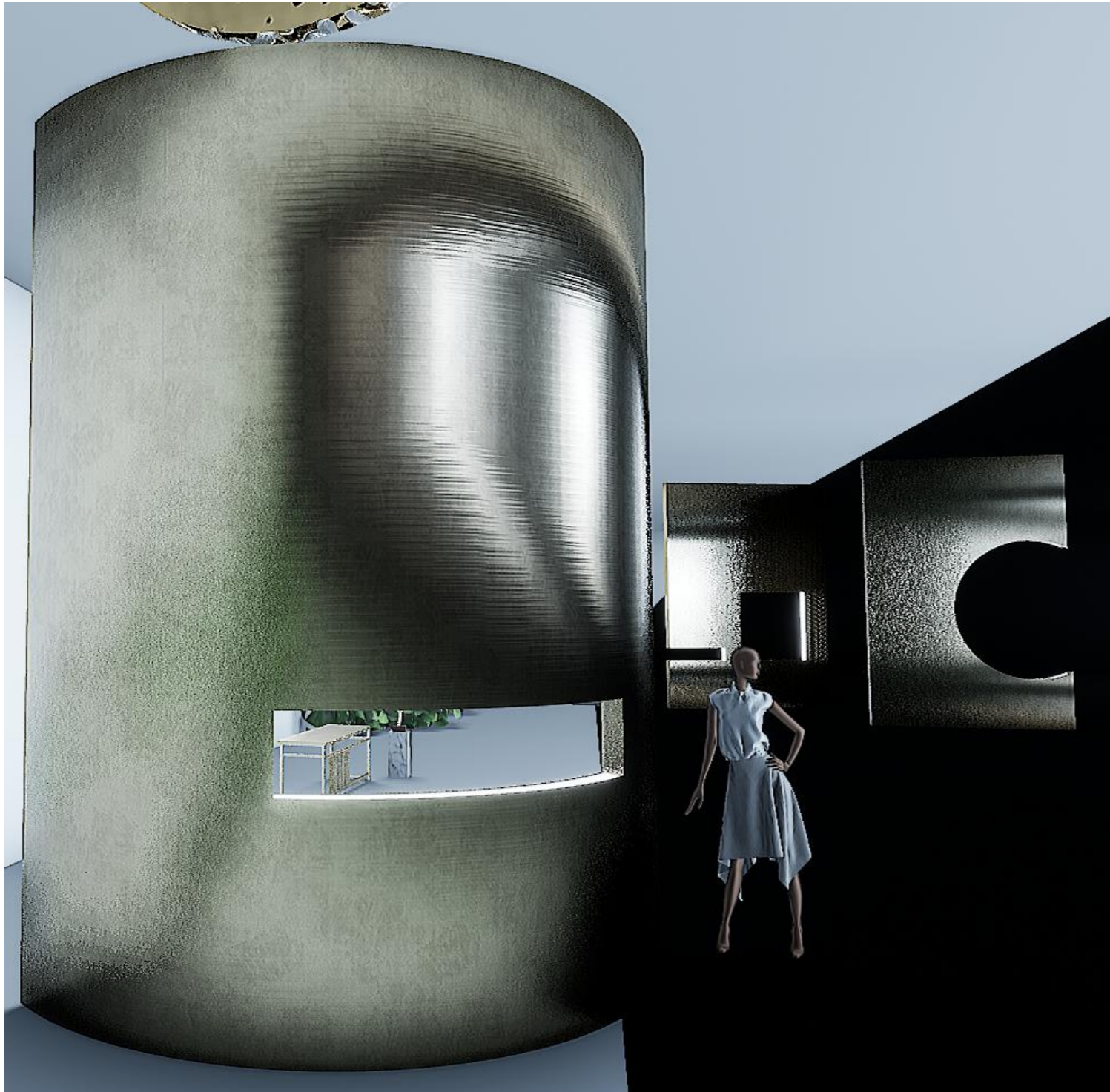

hairline honeycomb panel

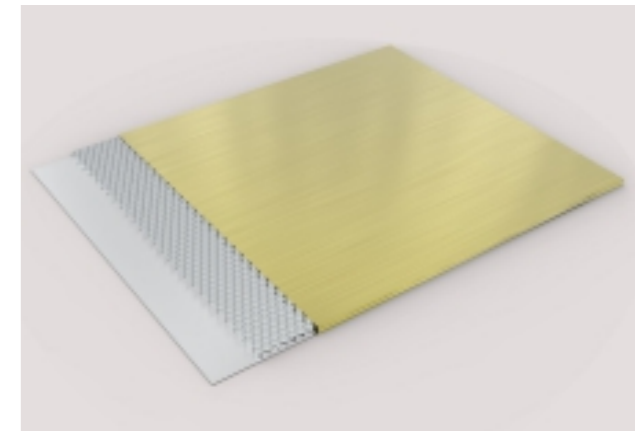

[COLLECTION]

hairline honeycomb panel

The surface of hairline honeycomb stainless steel honeycomb panel by hairline and titanium plating. hairline honeycomb stainless steel honeycomb panel can realize many ideas of designers

For example:

hanging columns

Hanging wall

Ultra thin modeling wall

Super thick modeling wall

ceiling system

Insect proof / waterproof / formaldehyde free / corrosion resistance, suitable for seashore environment



BLENDZ COLLECTION

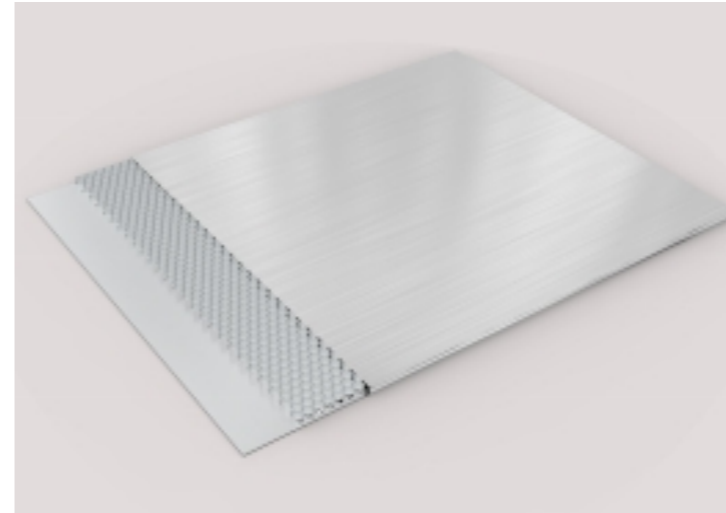

CM-LS801

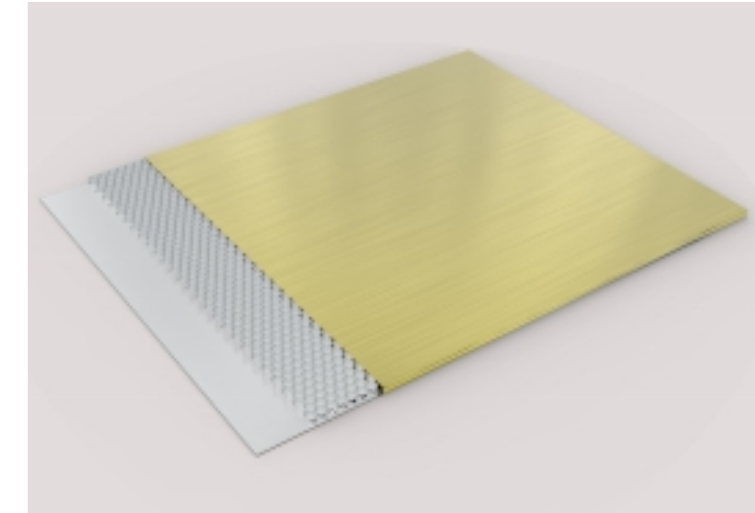

CM-LS802

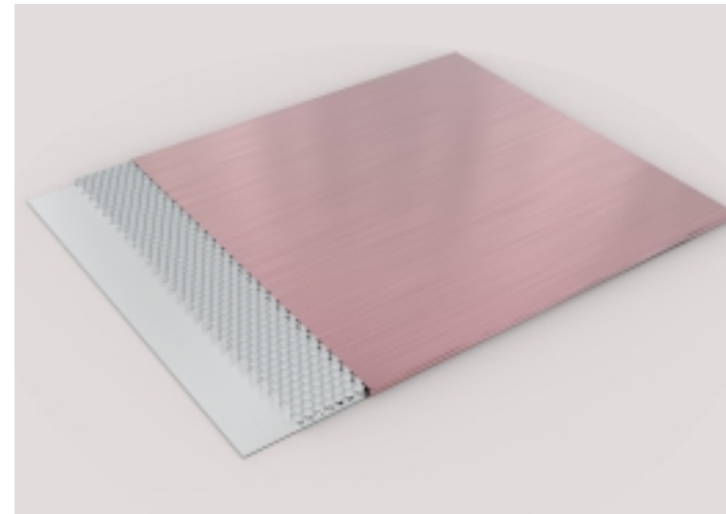

CM-LS803

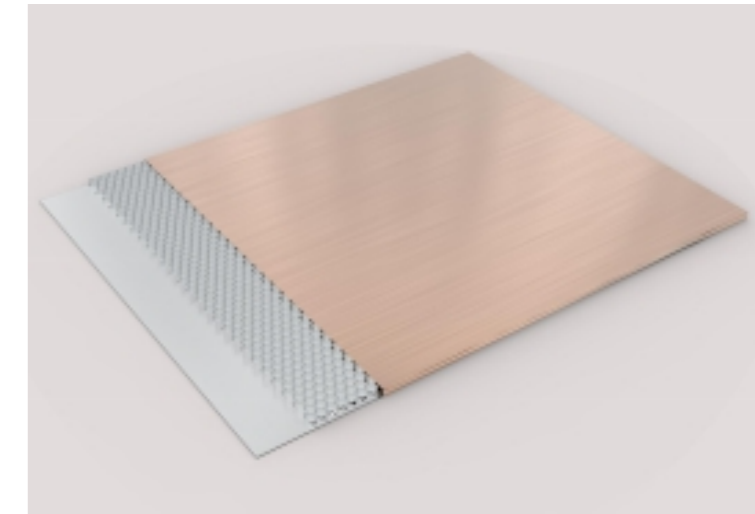

CM-LS804

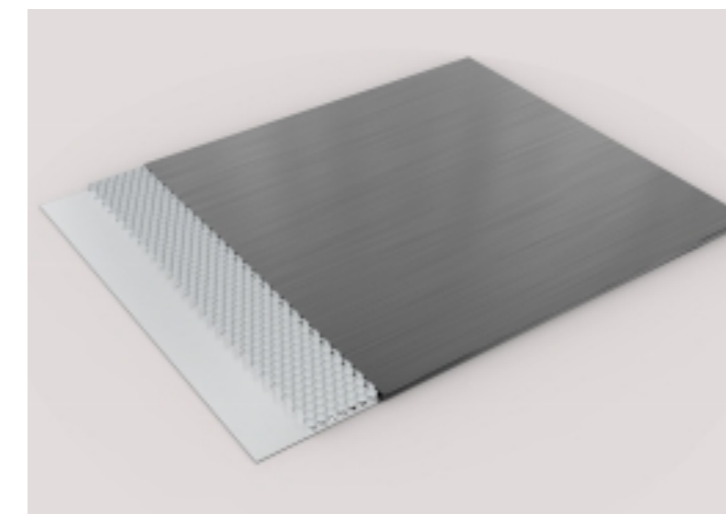

CM-LS805

grain pattern honeycomb panel

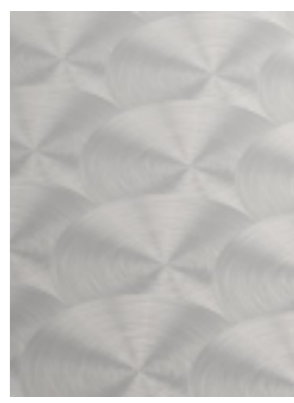
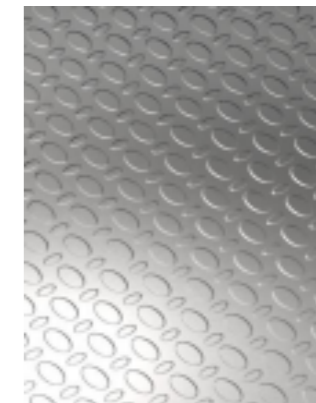
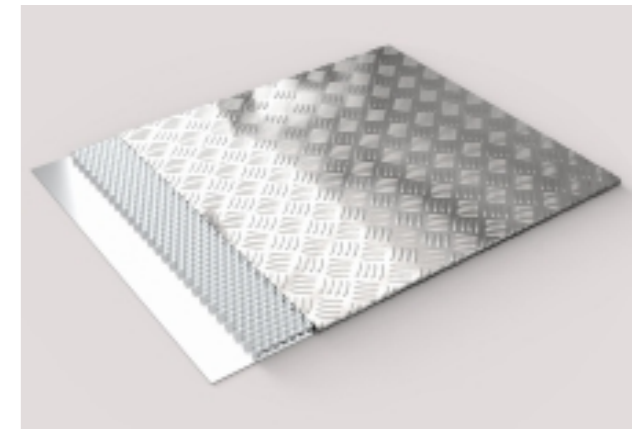

[COLLECTION]
grain pattern honeycomb panel

The surface of grain pattern stainless steel honeycomb panel is pressed by a large mould. grain pattern stainless steel honeycomb panel can realize many ideas of designers

- For example:
- hanging columns
- Hanging wall
- Ultra thin modeling wall
- Super thick modeling wall
- ceiling system
- Insect proof / waterproof / formaldehyde free / corrosion resistance, suitable for seashore environment

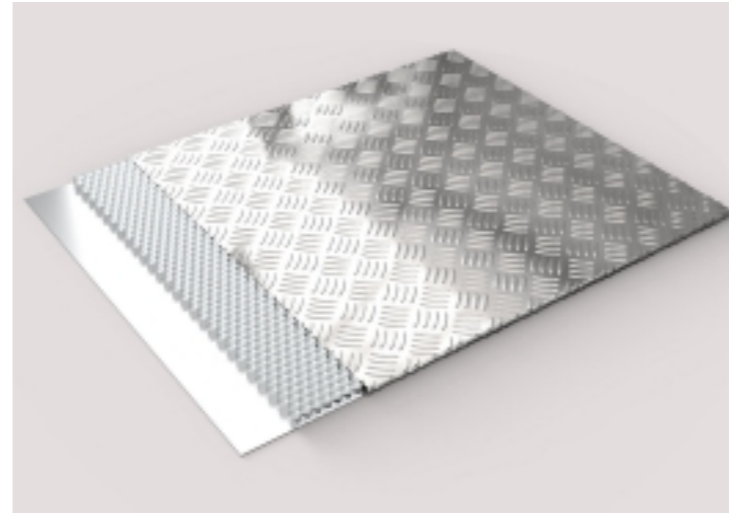

CM-YH806

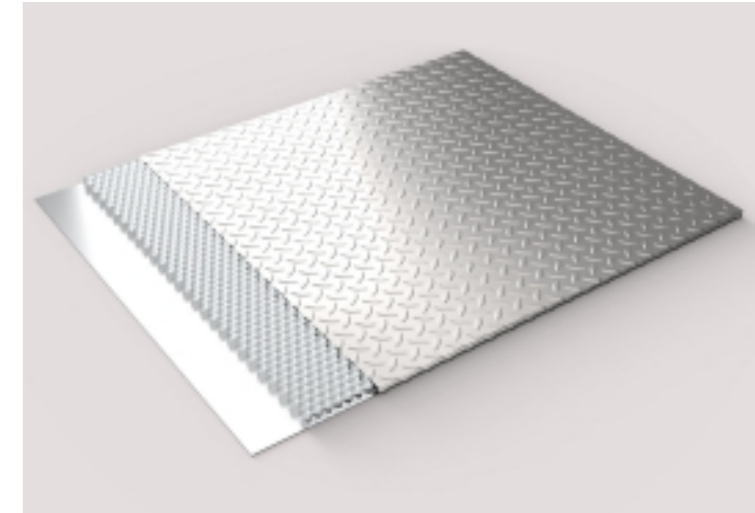

CM-YH807

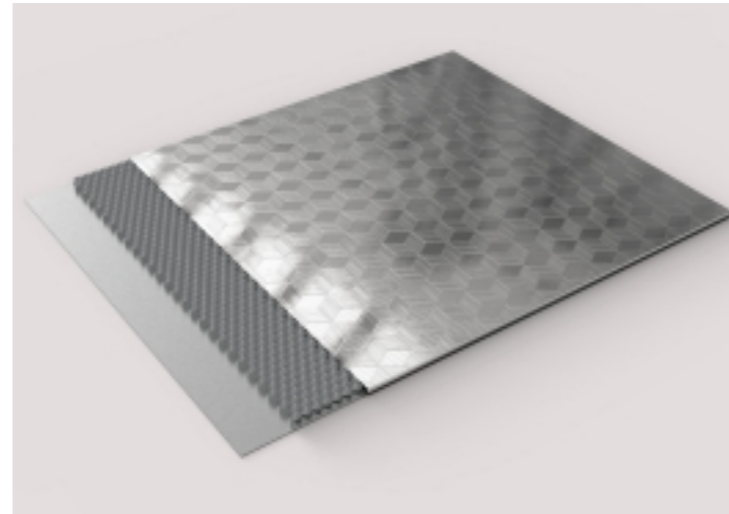

CM-YH808

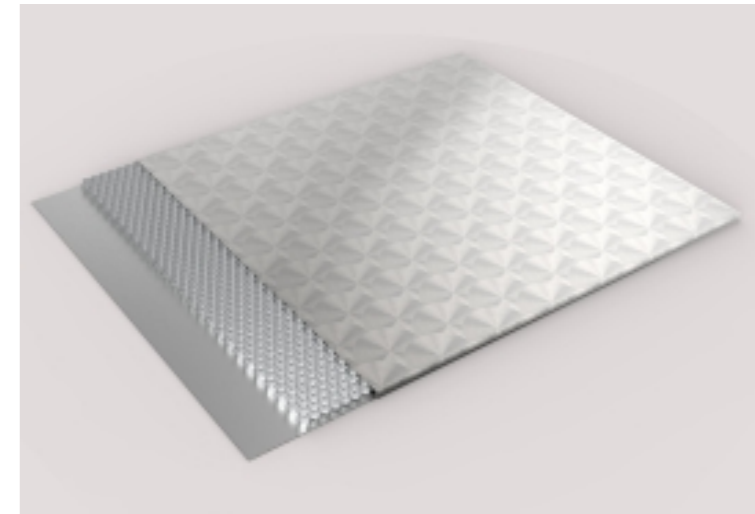

CM-YH809

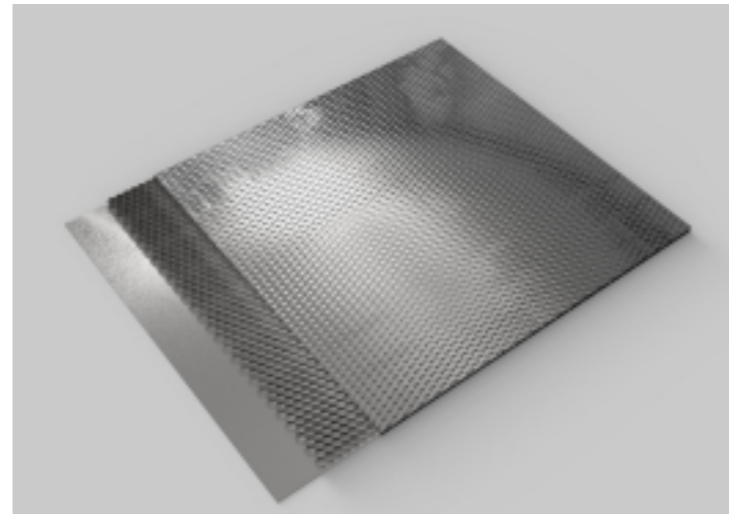

CM-YH810

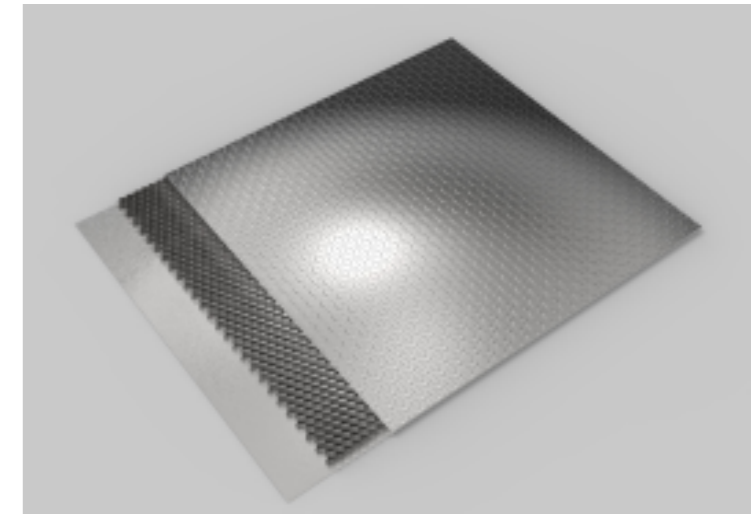

CM-YH811



brass plated honeycomb panel

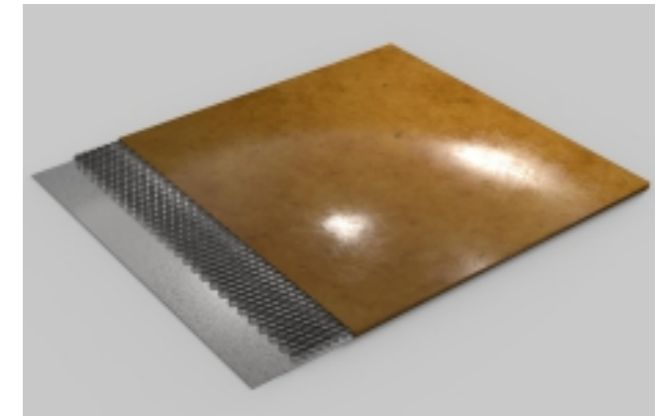

[COLLECTION]

Antique brass honeycomb panel

The surface of brass plated stainless steel honeycomb panel is frosted by copper and titanium plating process

brass plated stainless steel honeycomb panel can realize many ideas of designers

For example:

hanging columns

Hanging wall

Ultra thin modeling wall

Super thick modeling wall

ceiling system

Insect proof / waterproof / formaldehyde free / corrosion resistance, suitable for seashore environment



BLENDZ COLLECTION

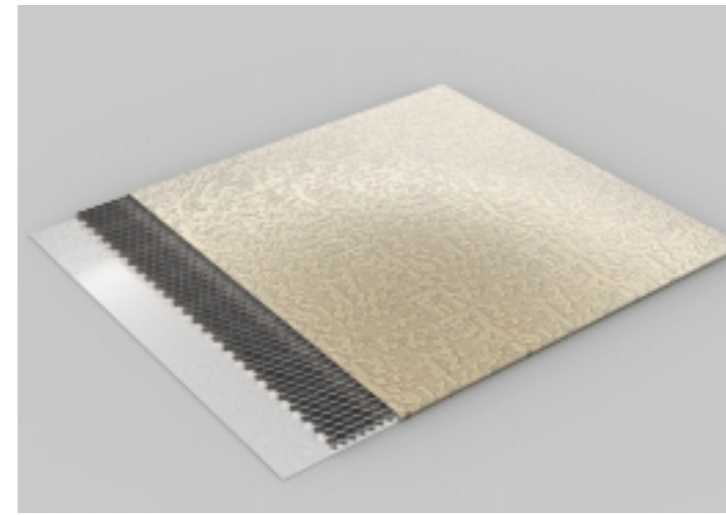

CM-GT801

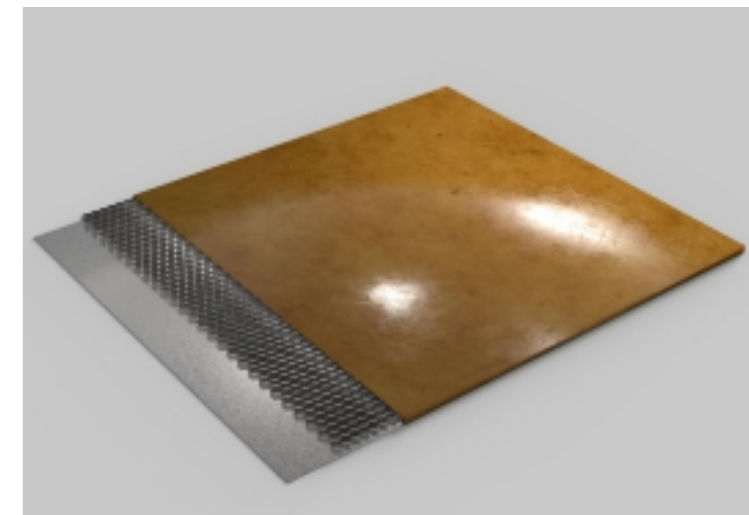

CM-GT802

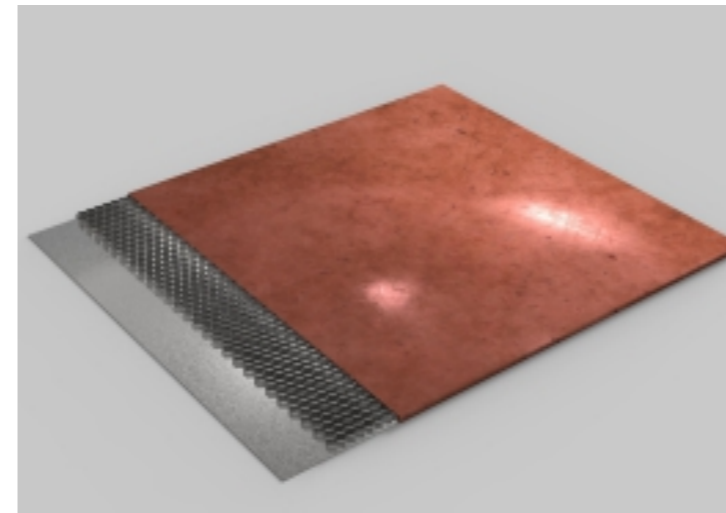

CM-GT803

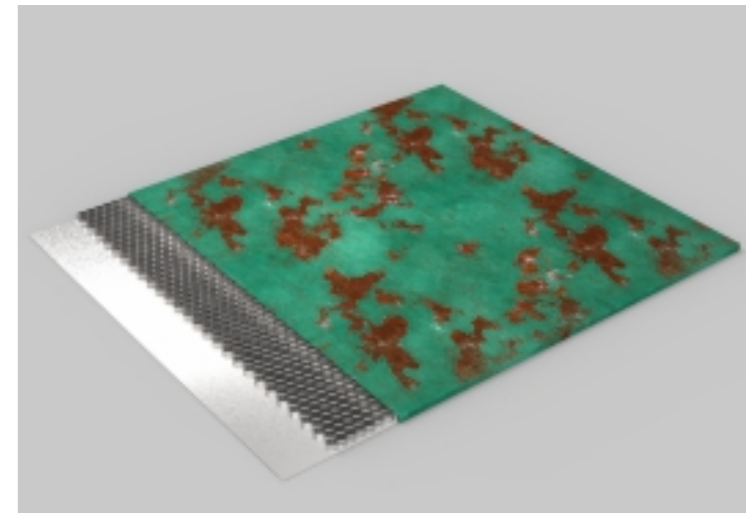

CM-GT8104

wooden pattern honeycomb panel

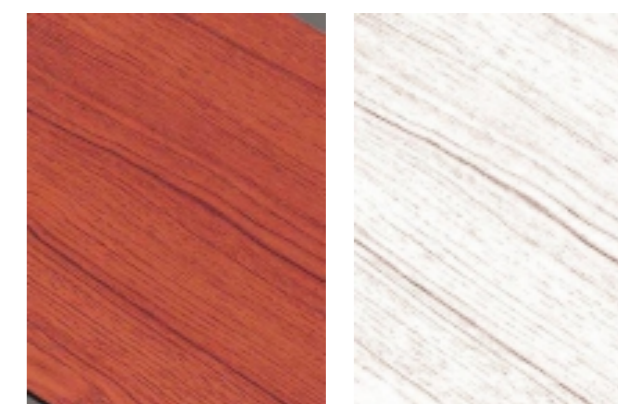
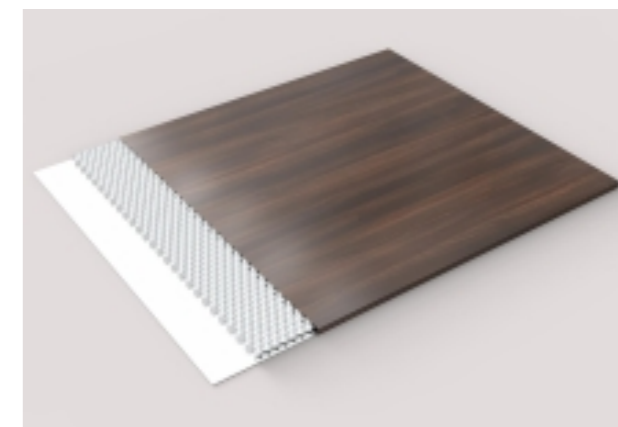

[COLLECTION]

wooden pattern honeycomb panel

The surface of wooden pattern stainless steel honeycomb panel is frosted by water transfer process
wooden pattern stainless steel honeycomb panel can realize many ideas of designers

For example:

hanging columns

Hanging wall

Ultra thin modeling wall

Super thick modeling wall

ceiling system

Insect proof / waterproof / formaldehyde free / corrosion resistance, suitable for seashore environment

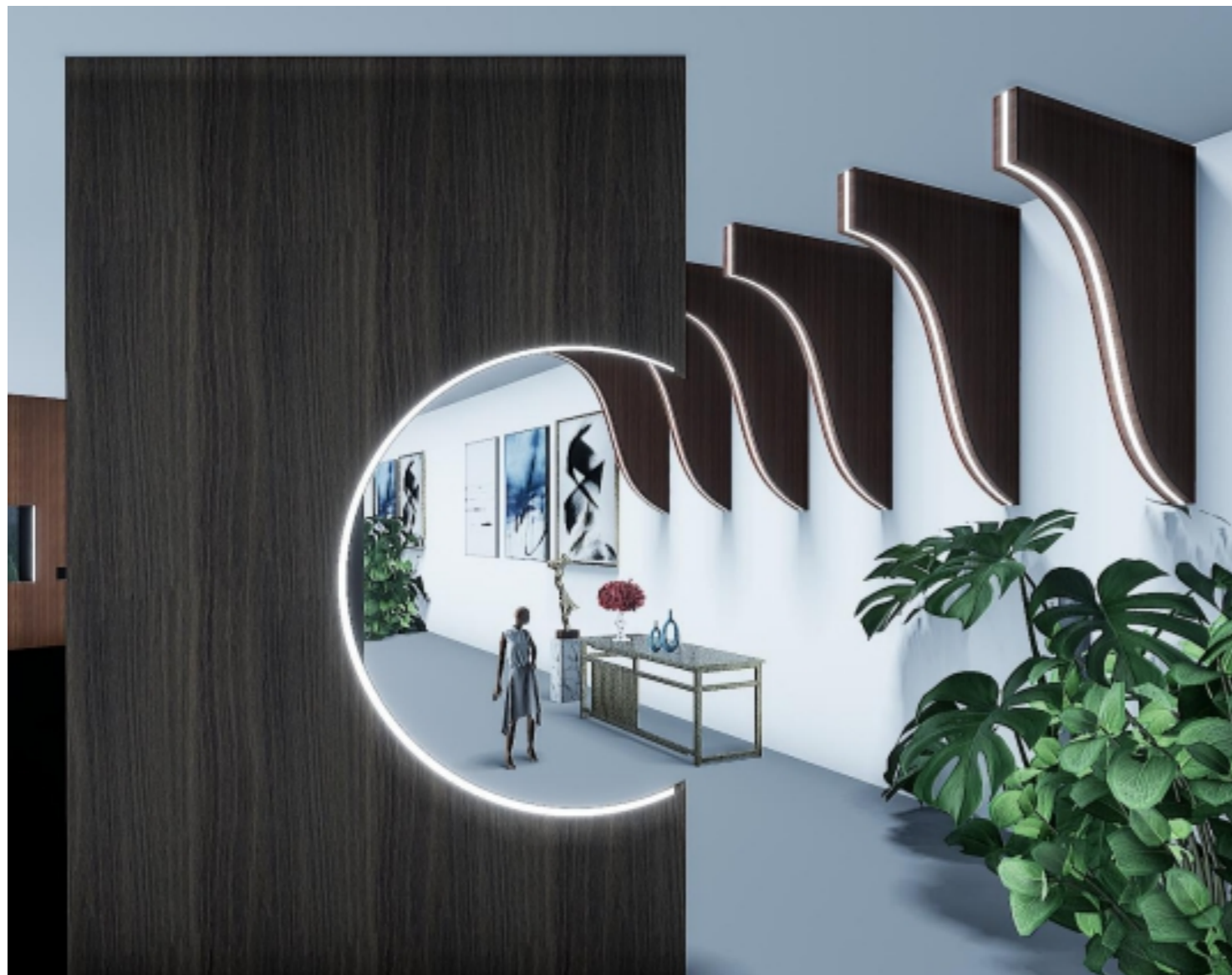

BLENDZ COLLECTION

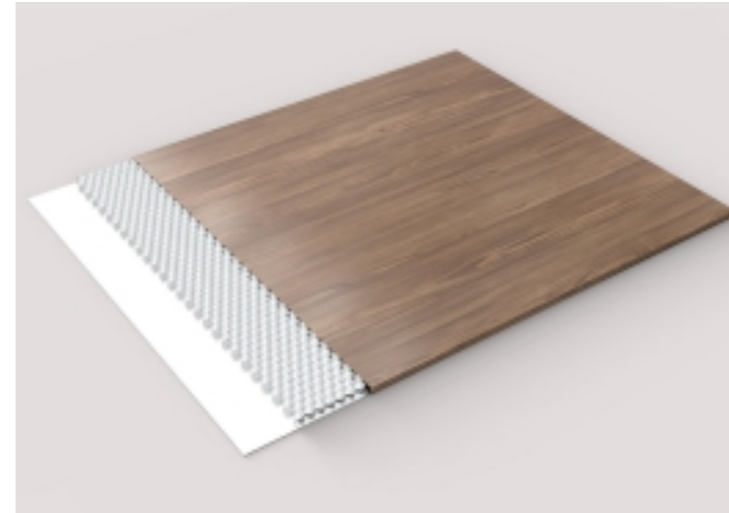

CM-MC801

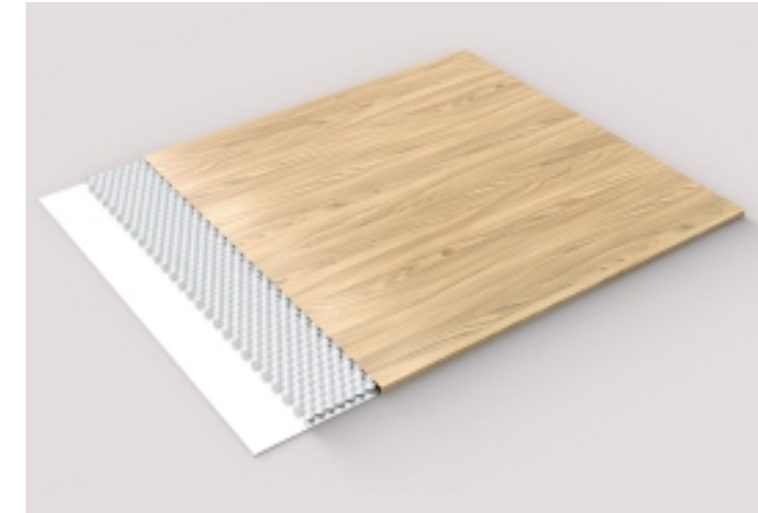

CM-MC802

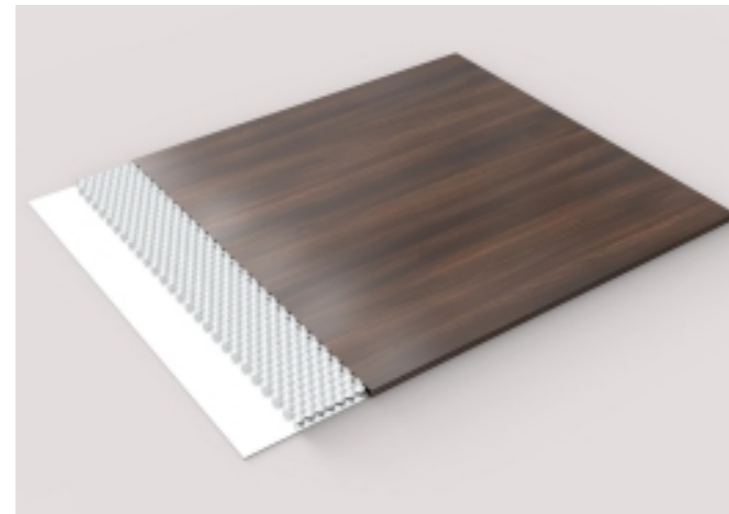

CM-MC803

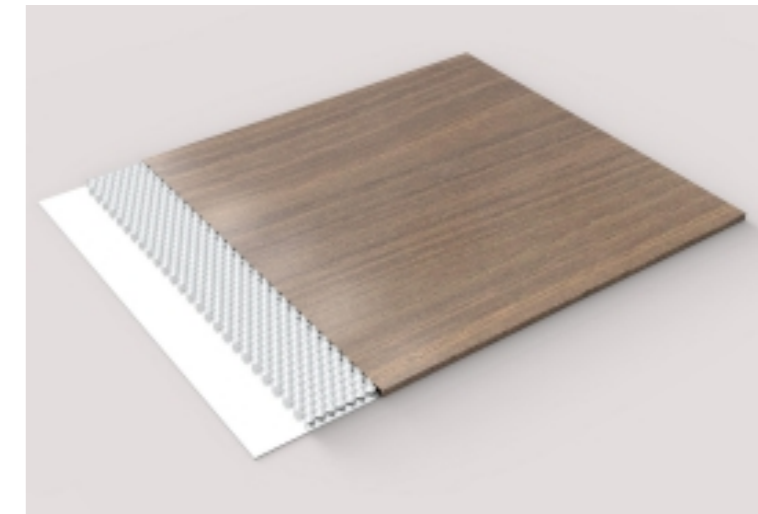

CM-MC804

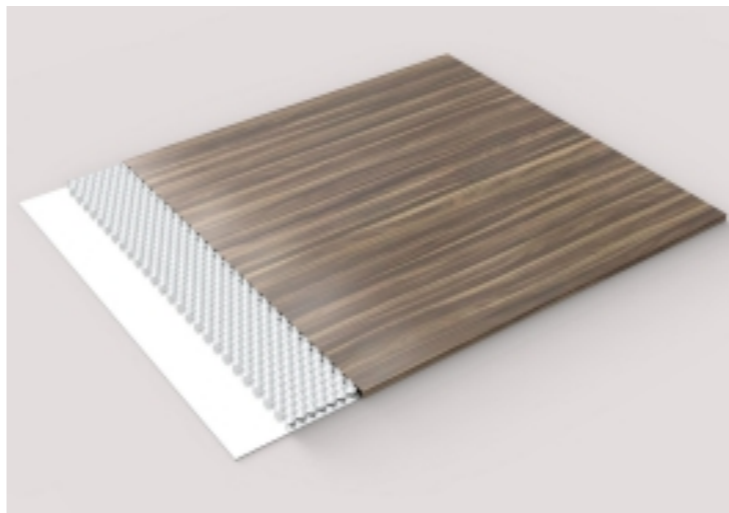

CM-MC805

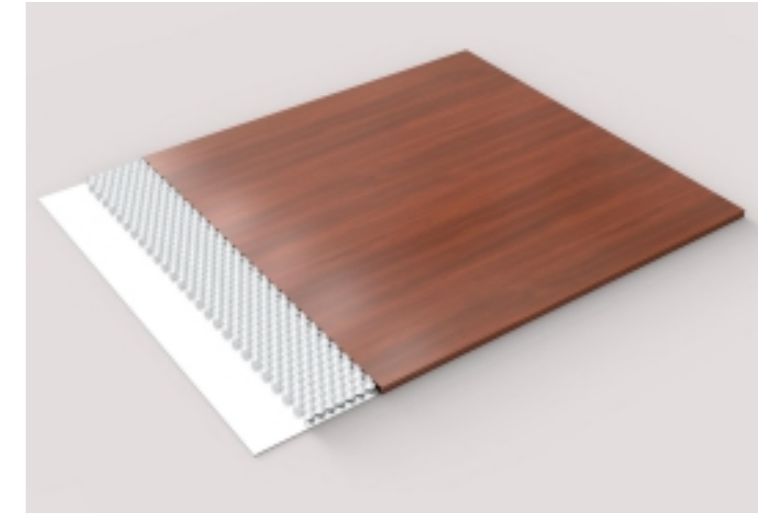

CM-MC806

marble pattern honeycomb panel

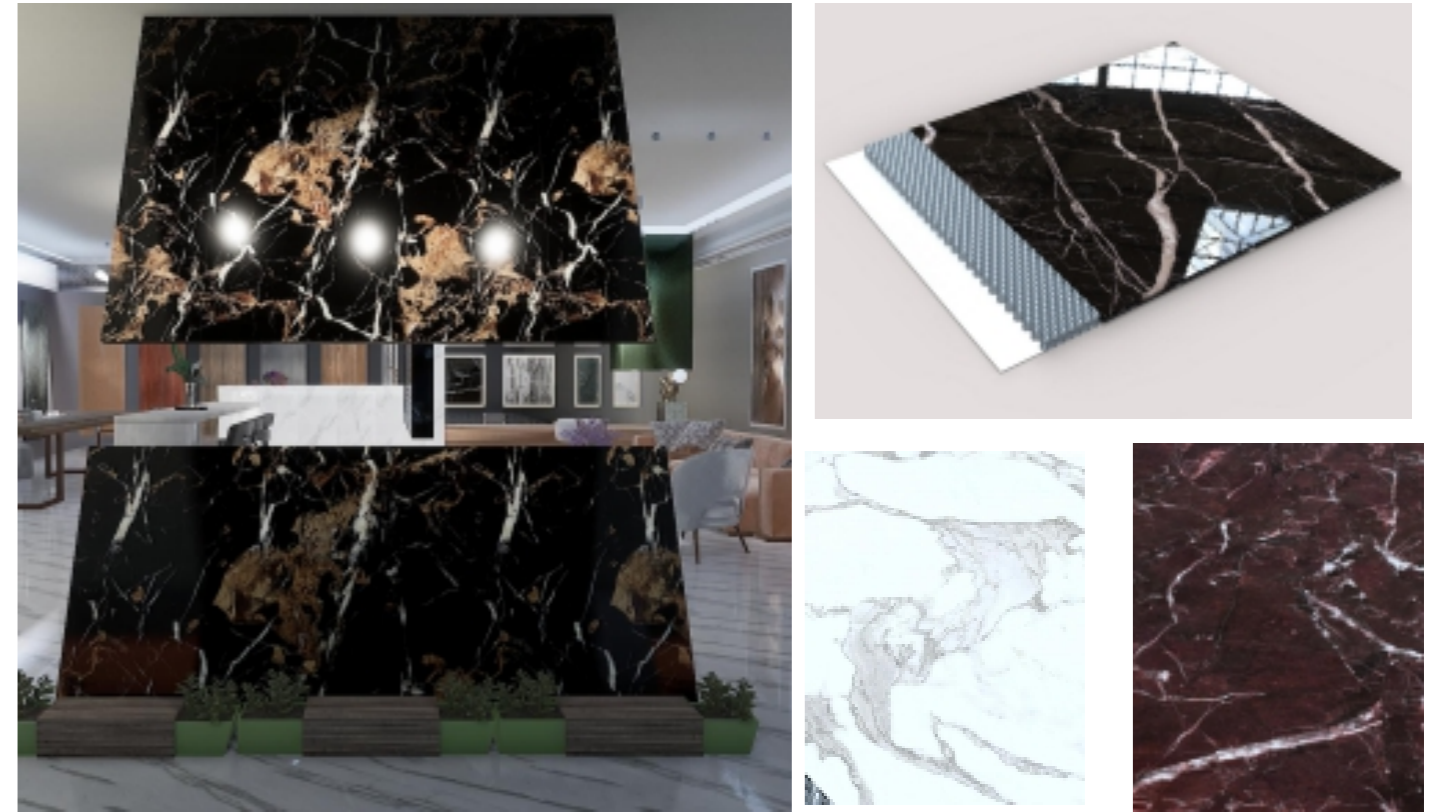

[COLLECTION]

marble pattern honeycomb panel

The surface of marble pattern stainless steel honeycomb panel is frosted by water transfer process marble pattern stainless steel honeycomb panel can realize many ideas of designers

- For example:
- hanging columns
 - Hanging wall
 - Ultra thin modeling wall
 - Super thick modeling wall
 - ceiling system
 - Insect proof / waterproof / formaldehyde free / corrosion resistance, suitable for seashore environment



GRADIENTS COLLECTION

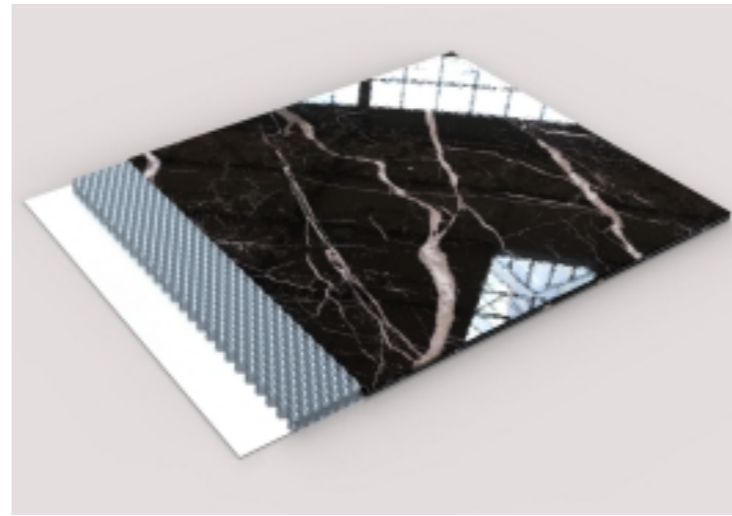

CM-DL801

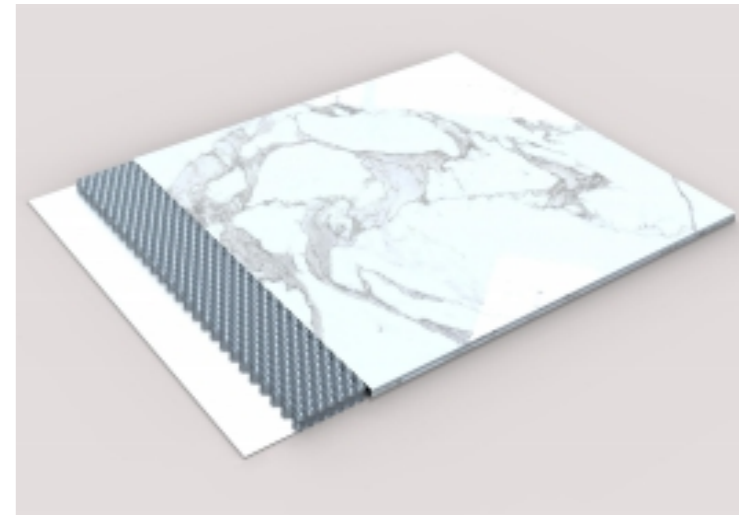

CM-DL802

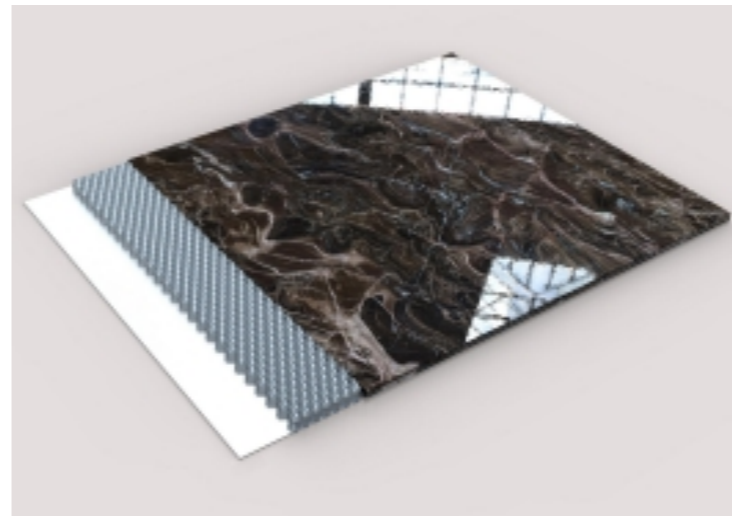

CM-DL803

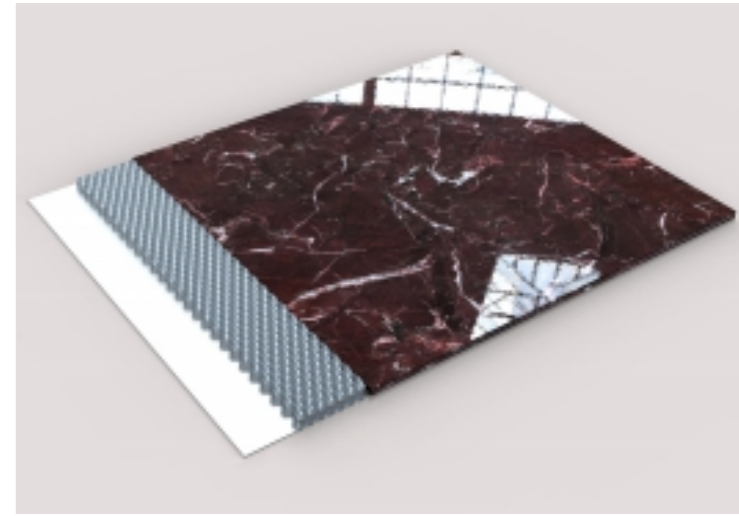

CM-DL804

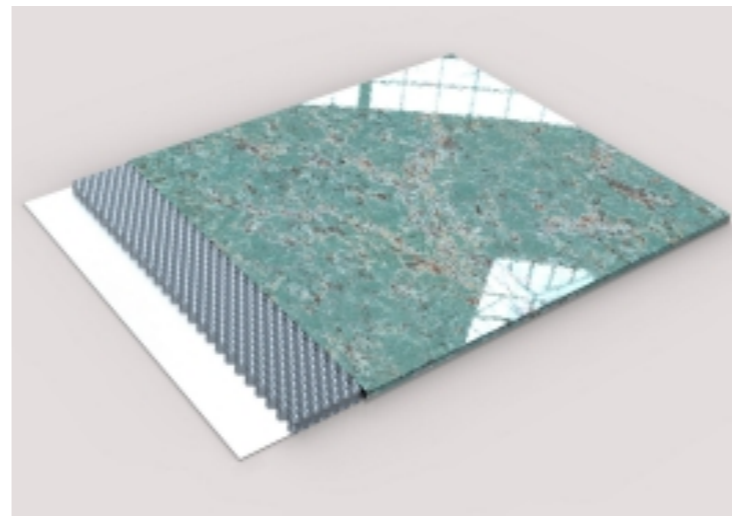

CM-DL805

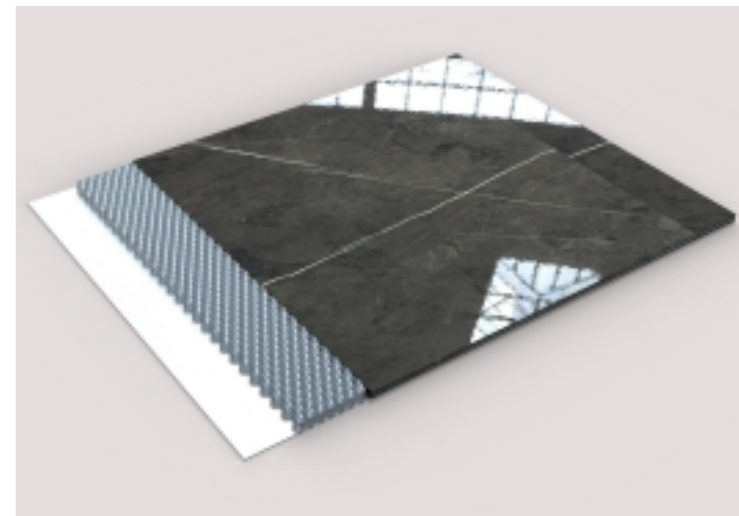

CM-DL806



rock pattern honeycomb panel

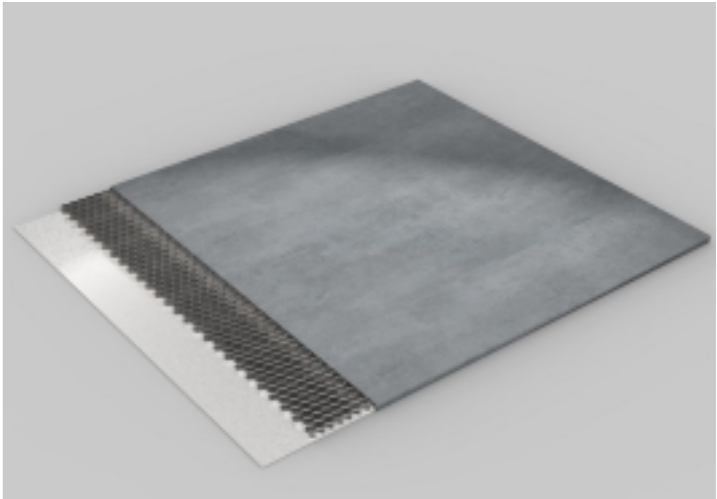

[COLLECTION]

rock pattern honeycomb panel

The surface of rock pattern stainless steel honeycomb panel is frosted by water transfer process
rock pattern stainless steel honeycomb panel can realize many ideas of designers

For example:

hanging columns

Hanging wall

Ultra thin modeling wall

Super thick modeling wall

ceiling system

Insect proof / waterproof / formaldehyde free / corrosion resistance, suitable for seashore environment



GRADIENTS COLLECTION

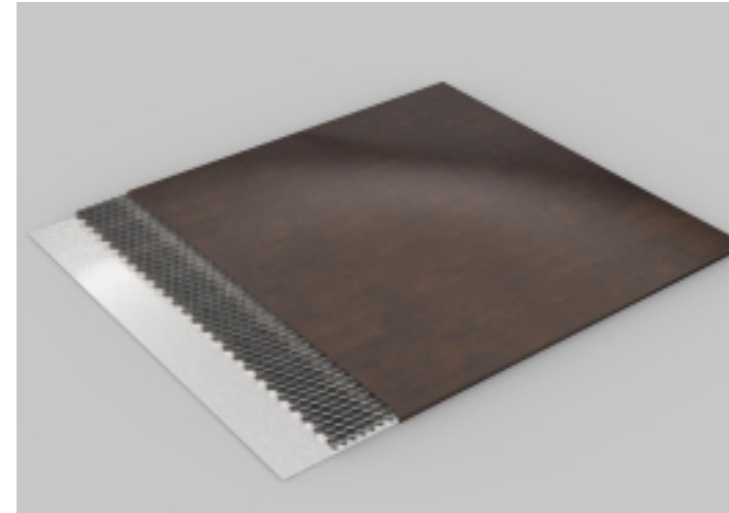

CM-YB801

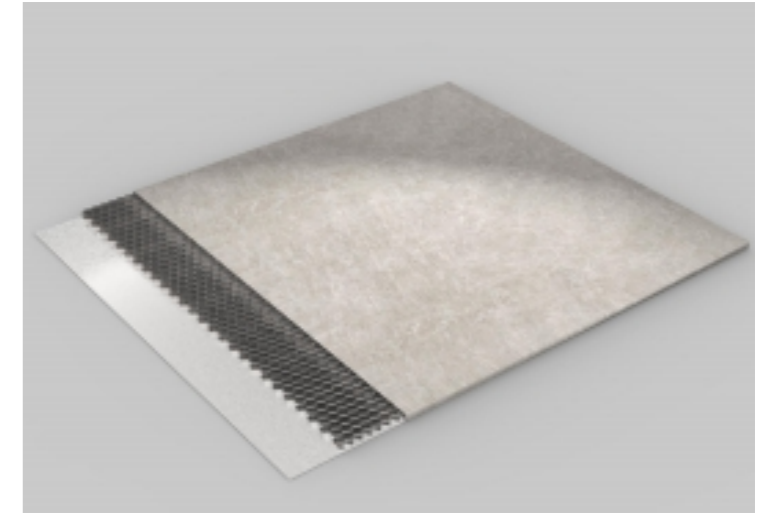

CM-YB802

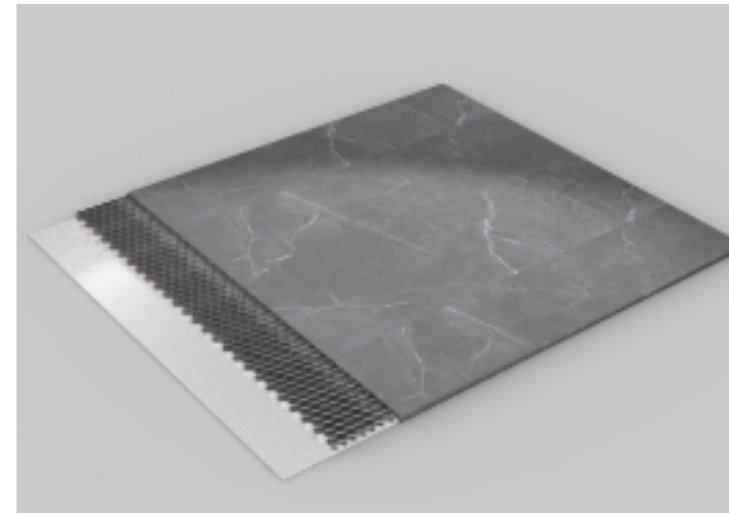

CM-YB803

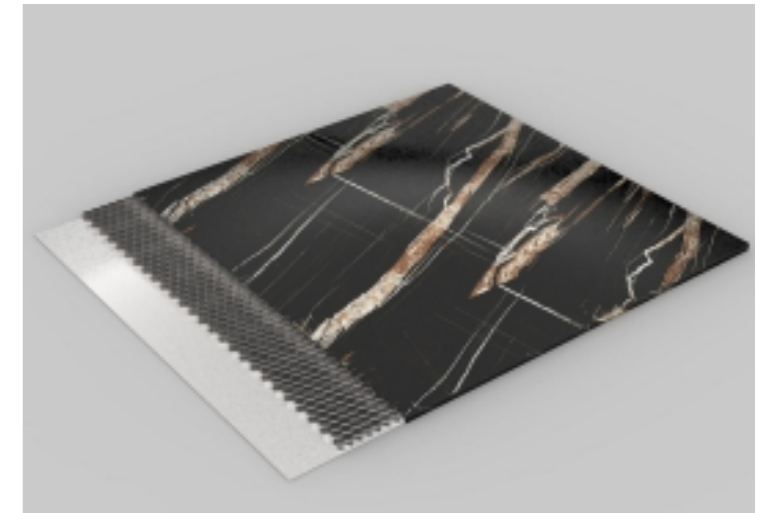

CM-YB804

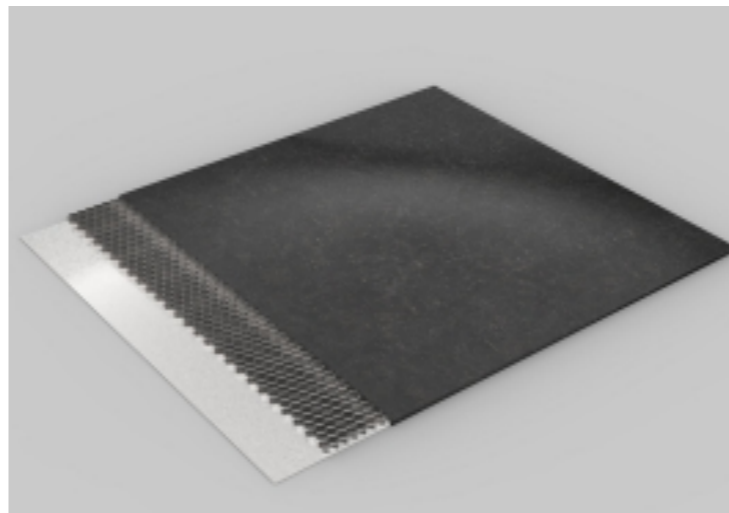

CM-YB805

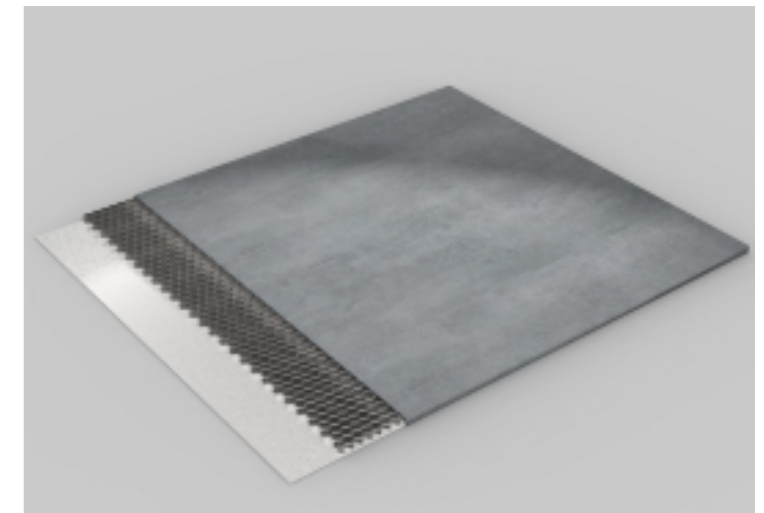

CM-YB806



CRAZY METAL

Redefine Architectural space





We Can Do It All For You

We are very happy to share with you our specially developed designer support program, so that you can complete the design and decoration projects more easily and smoothly, so as to help you raise your reputation in the industry. Your design expertise together with our new materials make us a successful combination and are doomed to create architectural history.

Crazy Metal

website : www.crzmetal.com

linkedin : [linkedin.com/company/crazy metal/](https://www.linkedin.com/company/crazy-metal/)

youtube : [youtube.crazymetal](https://www.youtube.com/c/crazymetal)

Contact : Stella:

Tel: 0086 18688779774

Email: _stella@crzmetal.com

Skype: [cmmiao@hotmail.com](https://www.hotmail.com)

Wechat(Whatsapp): 8618688779774

Adress: Building 7, Liuhe Science and Technology Park, Pingshan District, Shenzhen,Guangdong, China